



# US FRAMES SYSTEM

WE  
PROVIDE  
SCAFFOLDING  
GLOBALLY.

Building the Future.

CORONET 2025

# TABLE OF CONTENTS



## INTRODUCTION 02

## OVERVIEW 03-05

## US FRAMES 06-43

Snap-on Frame Scaffolding	06-11
Flip Lock Frame Scaffolding	12-13
Safway Style Frame Scaffolding	14-16
Biljax Style Frame Scaffolding	17-19
Waco Style Frame Scaffolding	20-21
Canadian Frame System	22-23
Shoring Frame System	24-25
Accessories	26-44



# ABOUT CORONET

Since its inception in the scaffolding business, the 'Coronet®' brand has stood for quality. With nearly two decades of successful operation, Coronet has emerged as the world's largest exporter of scaffolding to the North American market over the past years, as per the latest publicly available custom data.

Coronet USA serves as the American division of the Coronet Scaffolding Group. Our corporate offices are based in Suzhou, China, while our American operations are directed from offices in Houston, TX.

As a leading player in the scaffolding industry, we prioritize the well-being and happiness of our employees, whom we consider the cornerstone of our success. With values centered on 'customer first,' 'integrity,' and 'team cooperation,' Coronet stands out as an active, innovative, and passionate company. We extend our gratitude to all those who have placed their trust in Coronet over the years, and we welcome new customers to join us in our journey.



**CORONET'S VALUES**  
**Customers first, Integrity, Teamwork.**



# OVERVIEW

Coronet Quality

Coronet Products holds comprehensive product liability insurance provided by esteemed US carriers. We prioritize exceeding industry standards through our stringent quality assurance programs, ensuring that our scaffolding stands as the safest and most reliable worldwide.

At Coronet, we boast an in-house laboratory designed not just for material (mill) tests but also for diverse load testing, equipped with Transcell® load sensors. Our test engineers undergo rigorous training from accredited third parties, and we meticulously document and file test reports for complete traceability.

We firmly believe in hands-on action and going above and beyond.

## MATERIAL

Coronet only uses the high tensile steel S355 (The equivalent A572 Gr. 50, USA, ASTM. (min.yield of 50,000 psi/ min. tensile of 65,000 psi) for main parts in our products. Our steel is certified and test for every batch, meeting and exceeding industry standards.

## WELDING

Robert welding process monitoring and control involves routine or continuous monitoring of process variables, particularly current, time and force.

## FINISHING

Frame productions are finished and protected by hot-dipped zinc galvanizing or powder coated.This method of finishing maximizes surface durability.

## TRACEABILITY

Traceability imprinted code on all frames for quality assurance.



# OVERVIEW

## Product Traceability

**All coronet componets are stamped with traceability marks.**

Batch number: XXCSXXXX

XX=Serial Number CS= Coronet Scaffold YY=Month of Manufacture ZZ= Year of Manufacture

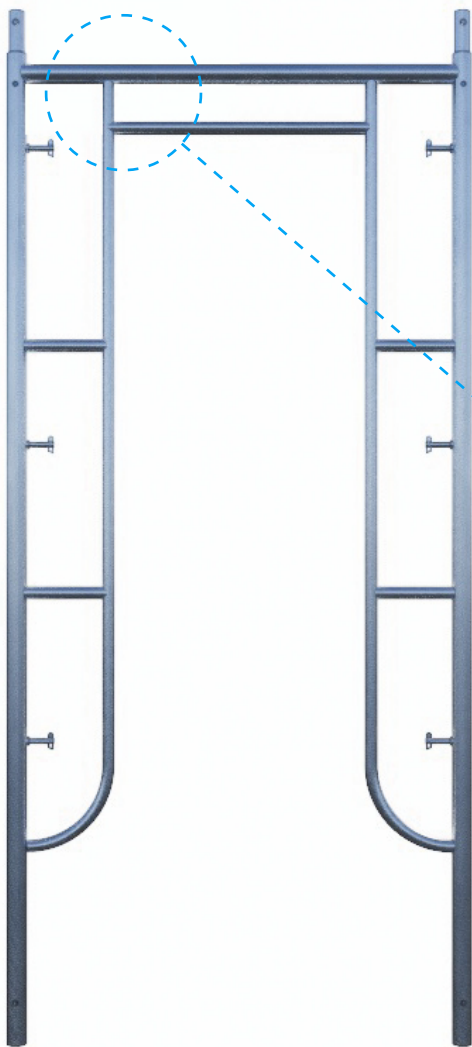

# OVERVIEW

## Component Overview

### Component Identification

The following diagram represents the most common Frame Scaffold components used. Most scaffold structure are made from these basic components yet the Frame System comes with a variety of accessories for all your scaffolding requirements.

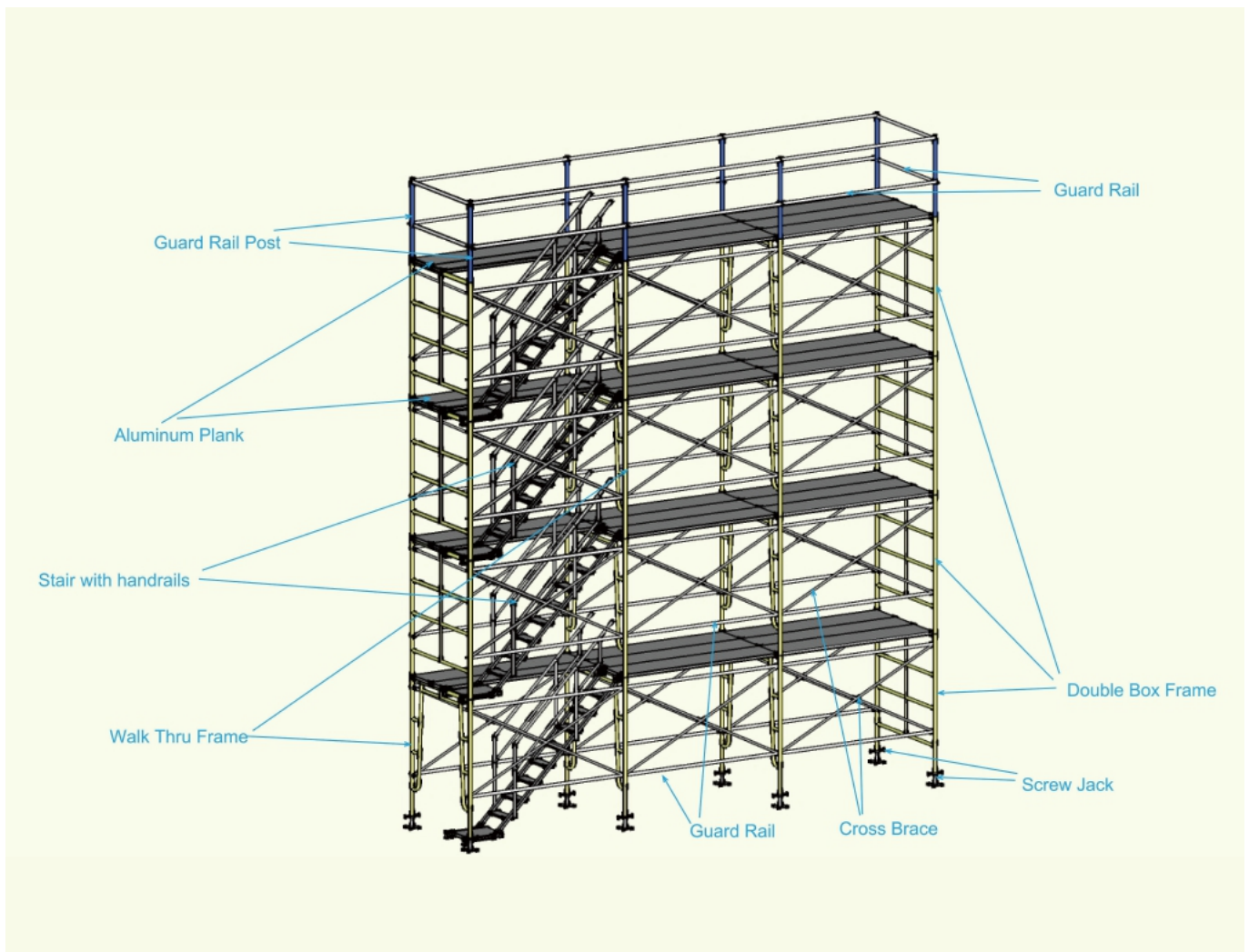

# Snap-on Frame Scaffolding

Walk Through Frame(1.625" OD), 6.5" measured from top frame to first lock, 2" from top frame to first hole at 90 degree direction.  
1-5/16" coupling pin with 1/8" Collar. Fixed in frame with Roll Pin.  
Q345 High Tensile Strength Tube for vertical legs.

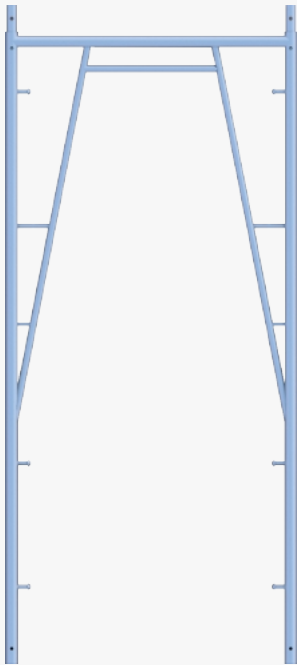

Item No.	Description	Weight (kgs)	Weight (lbs)	Surface Treatment
FS0427	2' x 6'8" Snap On Walk Thru Frame	14.05	30.95	Powder Coated
FS0669	3' x 4' Snap On Walk Thru Frame	10.83	23.85	Powder Coated
FS0672	3' x 5' Snap On Walk Thru Frame	13.45	29.63	Powder Coated
FS0296	3' x 6'8" Snap On Walk Thru Frame	15.60	34.36	Powder Coated
FS0639	5' x 6'8" Snap On Walk Thru Frame	19.30	42.51	Powder Coated

Snap-on Frame Scaffolding

Walk Through Frame w/18" Ladder(1.625" OD), 6.5" measured from top frame to first lock, 2" from top frame to first hole at 90 degree direction.  
1-5/16" coupling pin with 1/8" Collar. Fixed in frame with Roll Pin.  
Q345 High Tensile Strength Tube for vertical legs.

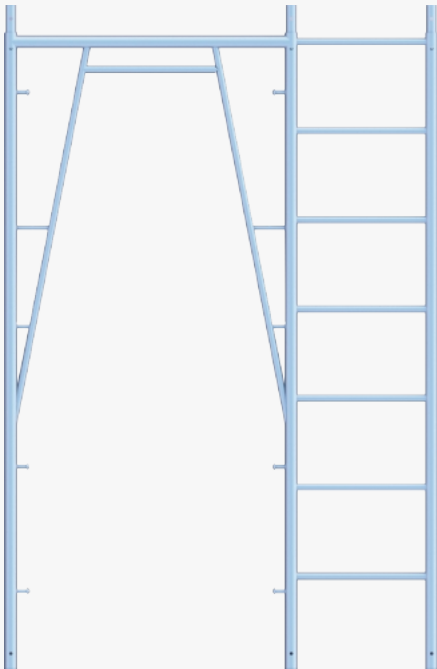

Item No.	Description	Weight (kgs)	Weight (lbs)	Surface Treatment
FS0670	3' x 4' Snap On Walk Thru Frame w/18" Ladder	15.90	35.02	Powder Coated
FS0428	3' x 5' Snap On Walk Thru Frame w/18" Ladder	19.50	42.95	Powder Coated
FS0633	3' x 6'8" Snap On Walk Thru Frame w/18" Ladder	23.60	51.98	Powder Coated
FS0429	5' x 6'8" Snap On Walk Thru Frame w/18" Ladder	28.10	61.89	Powder Coated



# Snap-on Frame Scaffolding

Apartment Frame(1.625" OD), 6.5" measured from top frame to first lock, 2" from top frame to first hole at 90 degree direction.  
1-5/16" coupling pin with 1/8" Collar. Fixed in frame with Roll Pin.  
Q345 High Tensile Strength Tube for vertical legs.

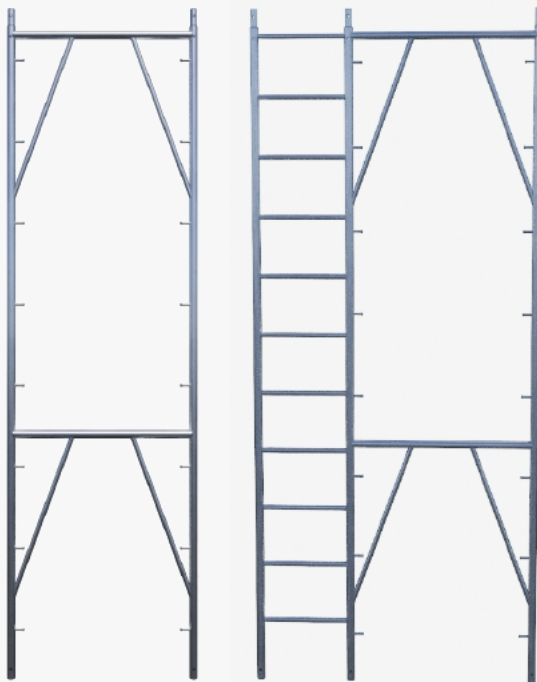

Item No.	Description	Weight (kgs)	Weight (lbs)	Surface Treatment
FS0430	2' x 8'8" Snap On Apartment Frame	18.60	40.97	Powder Coated
FS0629	2' x 10'8" Snap On Apartment Frame	22.70	50.00	Powder Coated
FS0671	3' x 8'8" Snap On Apartment Frame	20.66	45.51	Powder Coated
FS0630	3' x 10'8" Snap On Apartment Frame	24.38	53.70	Powder Coated
FS0432	3' x 8'8" Snap On Apartment Frame w/18" Ladder	30.65	67.51	Powder Coated
FS0431	3' x 10'8" Snap On Apartment Frame w/18" Ladder	35.00	77.09	Powder Coated

Snap-on Frame Scaffolding

Box Frame(1.625" OD), 6.5" measured from top frame to first lock, 2" from top frame to first hole at 90 degree direction.  
1-5/16" coupling pin with 1/8" Collar. Fixed in frame with Roll Pin.  
Q345 High Tensile Strength Tube for vertical legs.

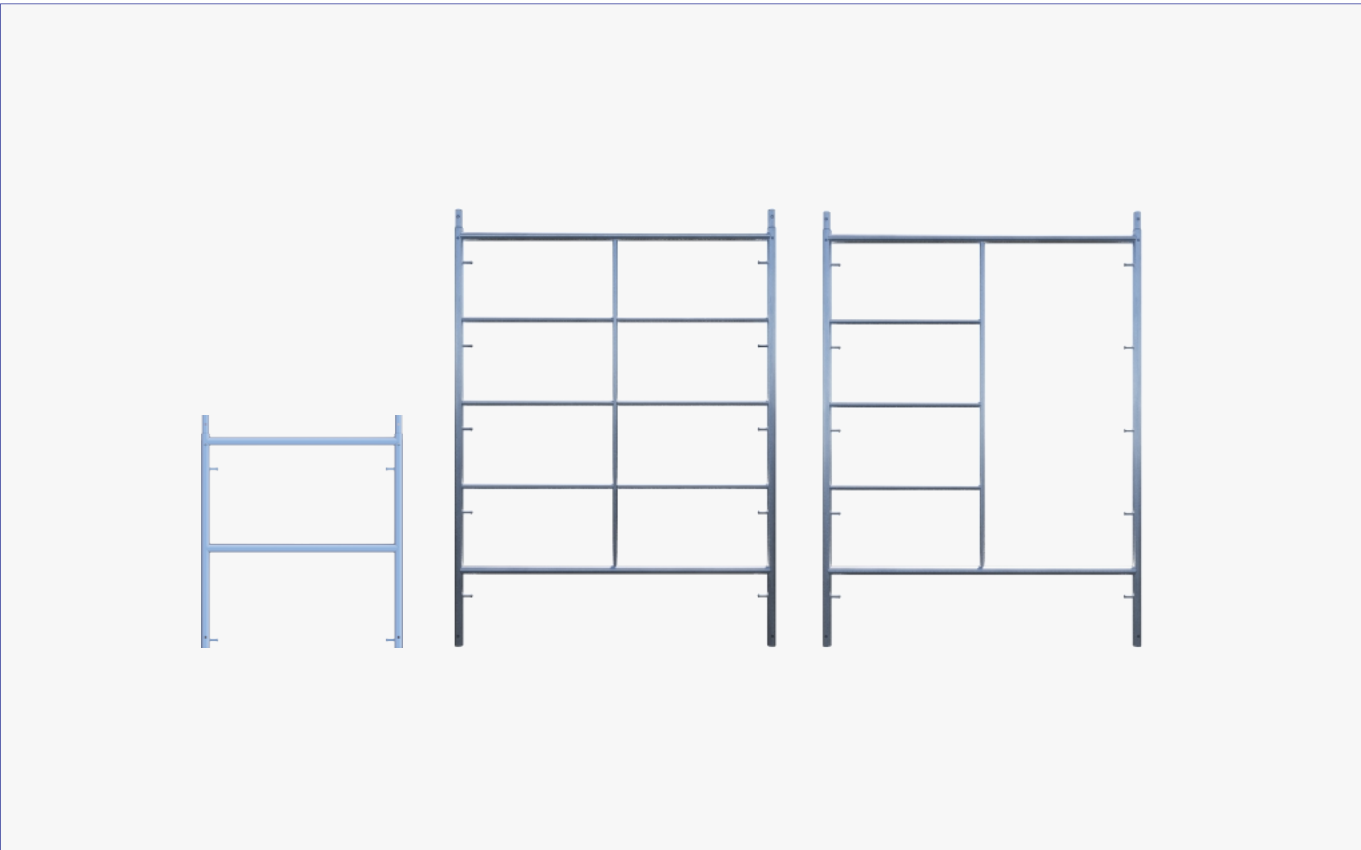

Item No.	Description	Weight (kgs)	Weight (lbs)	Surface Treatment
FS0665	3' x 20" Snap On Box Frame	7.10	15.64	Powder Coated
FS0667	3' x 40" Snap On Box Frame	9.20	20.26	Powder Coated
FS0433	5' x 4' Snap On Single Box Frame	14.90	32.82	Powder Coated
FS0435	5' x 5' Snap On Single Box Frame	16.70	36.78	Powder Coated
FS0436	5' x 6'8" Snap On Single Box Frame	20.70	45.59	Powder Coated
FS0640	5' x 4' Snap On Double Box Frame	15.75	34.69	Powder Coated
FS0434	5' x 5' Snap On Double Box Frame	19.25	42.40	Powder Coated
FS0437	5' x 6'8" Snap On Double Box Frame	23.80	52.42	Powder Coated

Snap-on Frame Scaffolding

Ladder Frame(1.625" OD), 6.5" measured from top frame to first lock, 2" from top frame to first hole at 90 degree direction  
1-5/16" coupling pin with 1/8" Collar. Fixed in frame with Roll Pin.  
Q345 High Tensile Strength Tube for vertical legs.



Item No.	Description	Weight (kgs)	Weight (lbs)	Surface Treatment
FS0438	2' x 5' Snap On Ladder Frame	12.50	27.53	Powder Coated
FS0439	2' x 6'8" Snap On Ladder Frame	14.30	31.50	Powder Coated
FS0627	3' x 4' Snap On Ladder Frame	12.30	27.09	Powder Coated
FS0440	3' x 5' Snap On Ladder Frame	13.50	29.74	Powder Coated
FS0441	3' x 6'8" Snap On Ladder Frame	15.80	34.80	Powder Coated

Snap-on Frame Scaffolding

Canopy Frame(1.625" OD), 6.5" measured from top frame to first lock, 2" from top frame to first hole at 90 degree direction  
1-5/16" coupling pin with 1/8" Collar. Fixed in frame with Roll Pin.  
Q345 High Tensile Strength Tube for vertical legs.

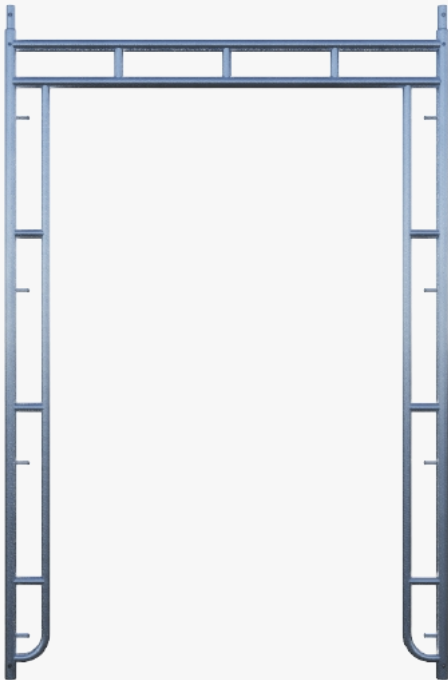

Item No.	Description	Weight (kgs)	Weight (lbs)	Surface Treatment
FS0662	5' x 7'6" Snap On Canopy Frame	25.00	55.07	Powder Coated
FS0663	6' x 7'6" Snap On Canopy Frame	27.70	61.01	Powder Coated



Flip Lock Frame Scaffolding

Walk Through Frame -(1.625" OD), 7" measured from top frame to first lock, 2.5" from top frame to first hole at 90 degree direction  
1-5/16"" coupling pin with no Collar. Fixed in frame with Roll Pin.  
Q345 High Tensile Strength Tube for vertical legs.

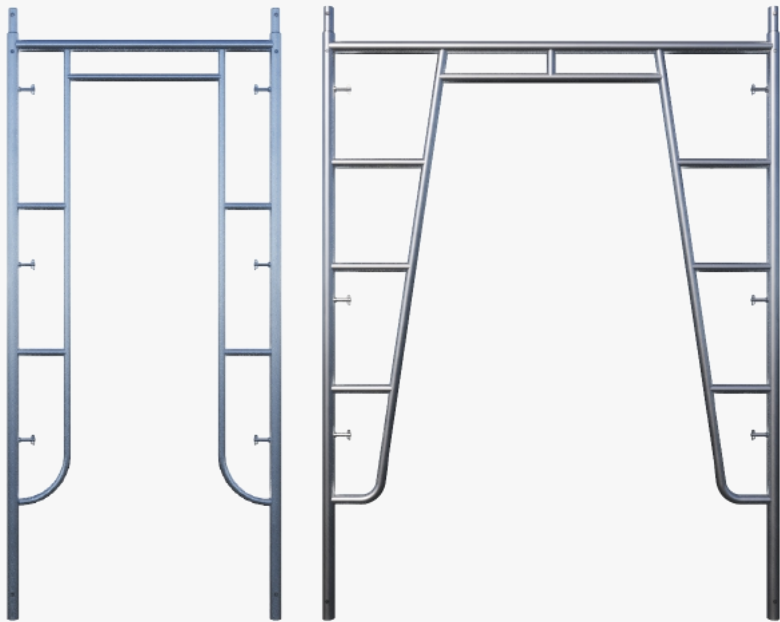

Item No.	Description	Weight (kgs)	Weight (lbs)	Surface Treatment
FS0637	3' x 6'7" Walk Thru Frame-Flip Lock	17.70	38.99	Powder Coated
FS0638	5' x 6'7" Walk Thru Frame-Flip Lock	22.00	48.46	Powder Coated

Flip Lock Frame Scaffolding

Box Frame -(1.625" OD), 7" measured from top frame to first lock, 2.5" from top frame to first hole at 90 degree direction  
1-5/16"" coupling pin with no Collar. Fixed in frame with Roll Pin.  
Q345 High Tensile Strength Tube for vertical legs.

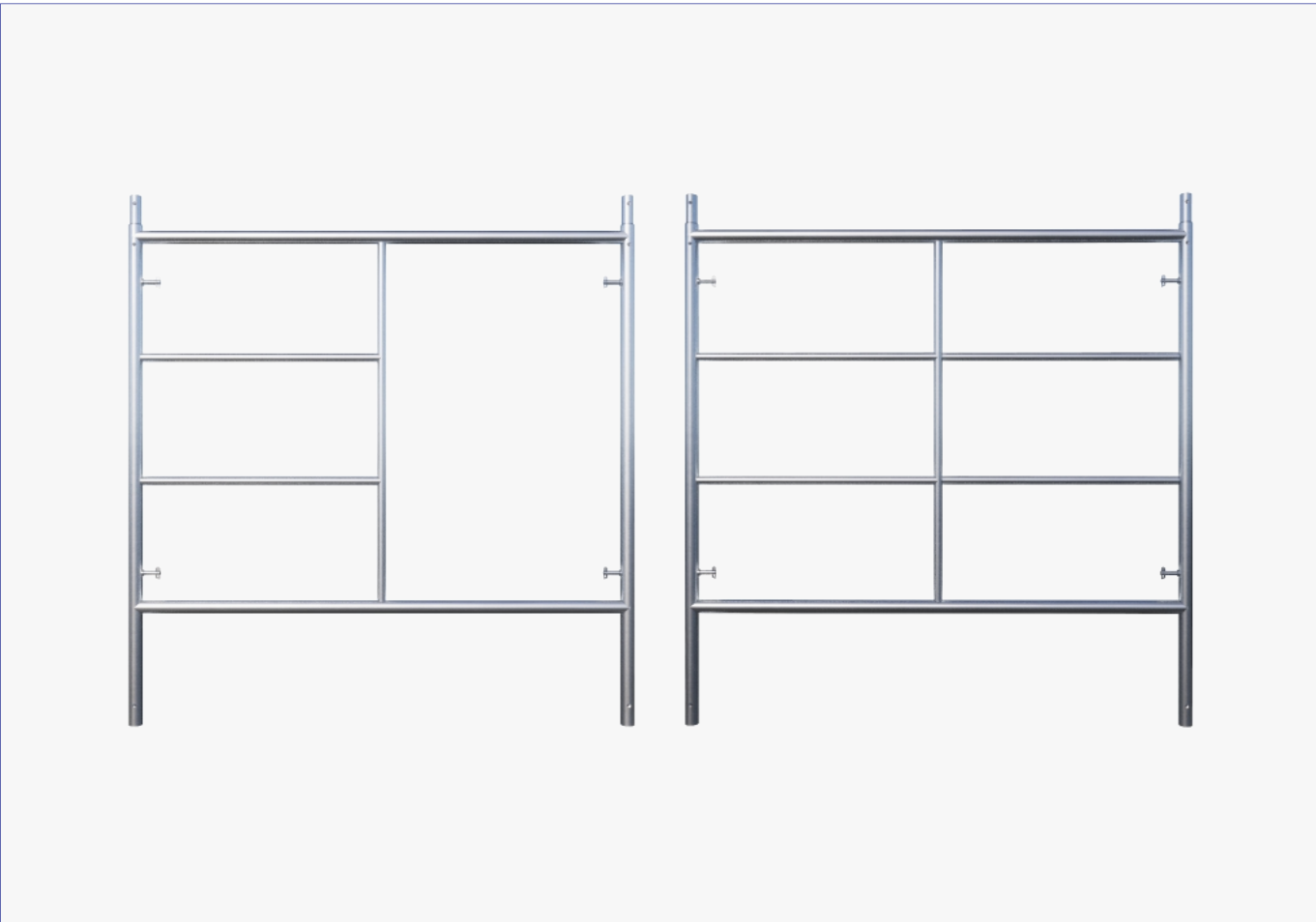

Item No.	Description	Weight (kgs)	Weight (lbs)	Surface Treatment
FS0442	5' x 4'1" Single Box Frame-Flip Lock	15.00	33.04	Powder Coated
FS0635	5' x 5'1" Single Box Frame-Flip Lock	17.20	37.89	Powder Coated
FS0634	5' x 6'7" Single Box Frame-Flip Lock	19.40	42.73	Powder Coated
FS0443	5' x 4'1" Double Box Frame-Flip Lock	15.80	34.80	Powder Coated
FS0444	5' x 5'1" Double Box Frame-Flip Lock	18.70	41.19	Powder Coated
FS0656	5' x 6'7" Double Box Frame-Flip Lock	23.00	50.66	Powder Coated

Safeway Style Frame Scaffolding

Walk Through Frame - "S" Style(1.69" OD), 8.5" measured from top frame to first lock, 2.5" from top frame to first hole at 45 degree direction  
1-3/8"" coupling pin with 1" Collar. Fixed in frame with Spring Retainer Pin.  
Q345 High Tensile Strength Tube for vertical legs.

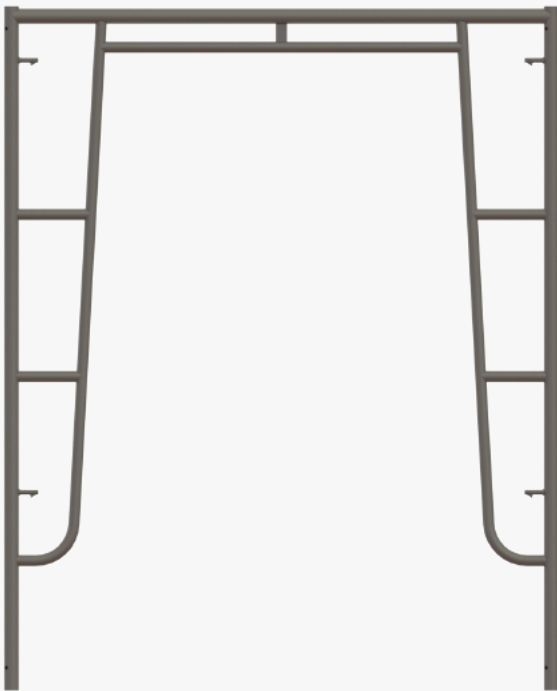

Item No.	Description	Weight (kgs)	Weight (lbs)	Surface Treatment
FS0445	3' x 5' Walk Thru Frame-Drop Lock	15.30	33.70	Powder Coated
FS0354	3' x 6'4" Walk Thru Frame-Drop Lock	18.10	39.87	Powder Coated
FS0446	42" x 5' Walk Thru Frame-Drop Lock	15.90	35.02	Powder Coated
FS0447	42" x 6'4" Walk Thru Frame-Drop Lock	18.50	40.75	Powder Coated
FS0448	5' x 6'4" Walk Thru Frame--Drop Lock	20.45	45.04	Powder Coated

Safeway Style Frame Scaffolding

Mason Frame - "S" Style ( OD1.69" OD), 8.5" measured from top frame to first lock, 2.5" from top frame to first hole at 45 degree direction.  
1-3/8" coupling pin with 1" Collar. Fixed in frame with Spring Retainer Pin.  
Q345 High Tensile Strength Tube for vertical legs.

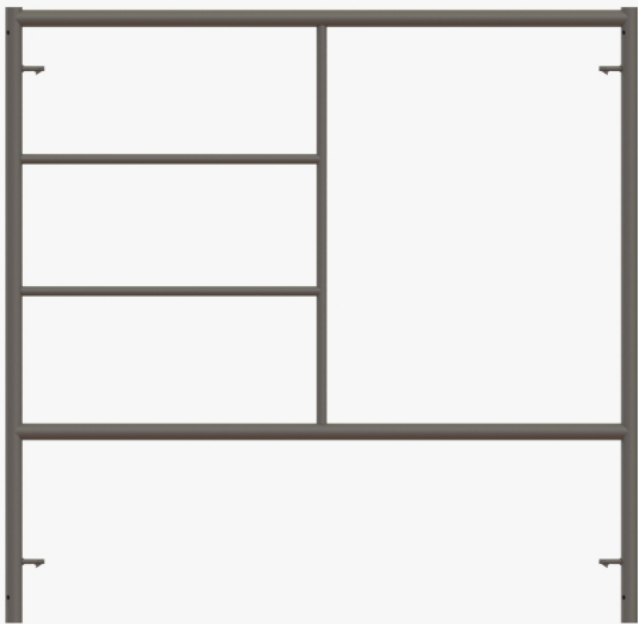

Item No.	Description	Weight (kgs)	Weight (lbs)	Surface Treatment
FS0449	5' x 2' Mason Frame-Drop Lock	10.70	23.57	Powder Coated
FS0450	5' x 3' Mason Frame-Drop Lock	12.30	27.09	Powder Coated
FS0451	5' x 4' Mason Frame-Drop Lock	15.00	33.04	Powder Coated
FS0452	5' x 5' Mason Frame-Drop Lock	16.67	36.72	Powder Coated
FS0453	5' x 6'4" Mason Frame-Drop Lock	19.90	43.83	Powder Coated



Safeway Style Frame Scaffolding

Ladder Frame - "S" Style ( OD1.69" OD), 8.5" measured from top frame to first lock, 2.5" from top frame to first hole at 45 degree directio.

1-3/8" coupling pin with 1" Collar. Fixed in frame with Spring Retainer Pin.

Q345 High Tensile Strength Tube for vertical legs.



Item No.	Description	Weight (kgs)	Weight (lbs)	Surface Treatment
FS0454	2' x 5' Ladder Frame-Drop Lock	10.70	23.57	Powder Coated
FS0455	2' x 6'4" Ladder Frame-Drop Lock	13.50	29.74	Powder Coated
FS0456	3' x 5' Ladder Frame-Drop Lock	12.40	27.31	Powder Coated
FS0457	3' x 6'4" Ladder Frame-Drop Lock	15.60	34.36	Powder Coated

Vanguard Style Frame Scaffolding

Walk Through Frame - "Vanguard" Style(1.69" OD), 6" measured from top frame to first lock, 2.5" from top frame to first hole at 45 degree direction.  
1-3/8" coupling pin with 1" Collar. Fixed in frame with Spring Retainer Pin.  
Q345 High Tensile Strength Tube for vertical legs.

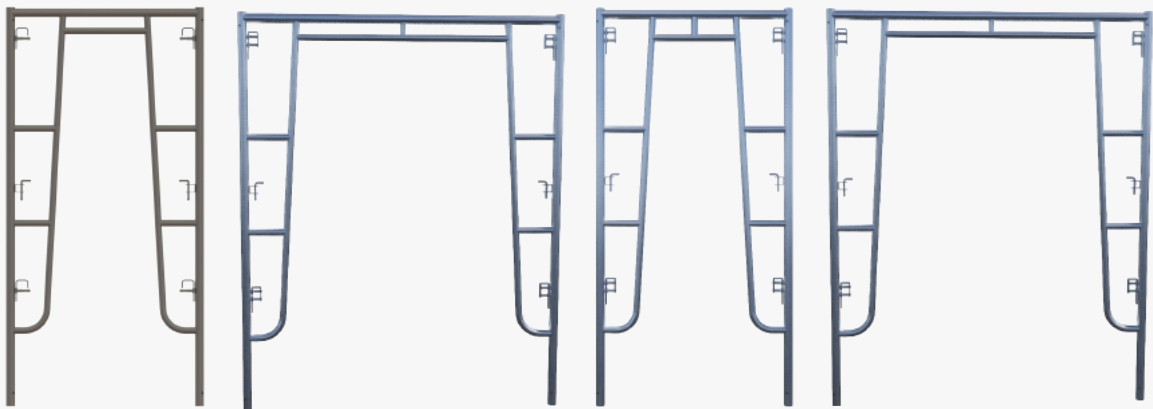

Item No.	Description	Weight (kgs)	Weight (lbs)	Surface Treatment
FS0473	3' x 6'4" Walk Thru Frame-V Lock	19.50	42.95	Powder Coated
FS0474	42" x 6'4" Walk Thru Frame-V Lock	20.50	45.15	Powder Coated
FS0338	5' x 6'4" Walk Thru Frame-V Lock	21.50	47.36	Powder Coated
FS0075	3' x 6'4" Walk Thru Frame-Slide Lock	19.90	43.83	Powder Coated
FS0577	42" x 6'4" Walk Thru Frame-Slide Lock	20.90	46.04	Powder Coated
FS0506	5' x 6'4" Walk Thru Frame-Slide Lock	21.90	48.24	Powder Coated

Vanguard Style Frame Scaffolding

Mason Frame - "Vanguard" Style(1.69" OD), 6" measured from top frame to first lock, 2.5" from top frame to first hole at 45 degree direction.  
1-3/8" coupling pin with 1" Collar. Fixed in frame with Spring Retainer Pin.  
Q345 High Tensile Strength Tube for vertical legs.

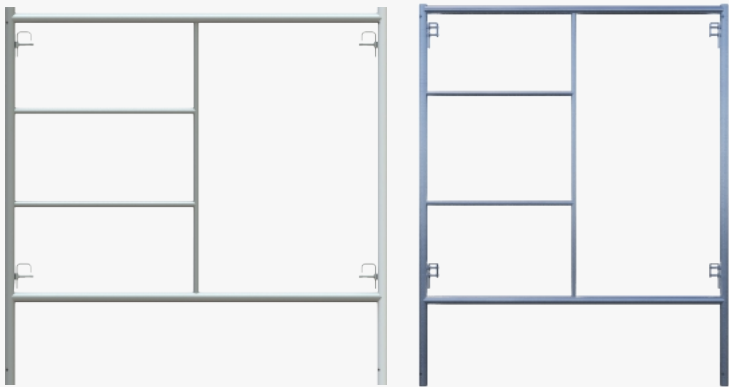

Item No.	Description	Weight (kgs)	Weight (lbs)	Surface Treatment
FS0476	5' x 2' Mason Frame-V Lock	11.50	25.33	Powder Coated
FS0477	5' x 3' Mason Frame-V Lock	13.20	29.07	Powder Coated
FS0478	5' x 4' Mason Frame-V Lock	15.80	34.80	Powder Coated
FS0489	5' x 5' Mason Frame-V Lock	18.40	40.53	Powder Coated
FS0490	5' x 6'4" Mason Frame-V Lock	21.00	46.26	Powder Coated
FS0135	5' x 2' Mason Frame-Slide Lock	11.90	26.21	Powder Coated
FS0142	5' x 3' Mason Frame-Slide Lock	13.60	29.96	Powder Coated
FS0147	5' x 4' Mason Frame-Slide Lock	16.20	35.68	Powder Coated
FS0154	5' x 5' Mason Frame-Slide Lock	18.80	41.41	Powder Coated
FS0157	5' x 6'4" Mason Frame-Slide Lock	21.40	47.14	Powder Coated

Vanguard Style Frame Scaffolding

Ladder Frame - "Vanguard" Style(1.69" OD), 6" measured from top frame to first lock, 2.5" from top frame to first hole at 45 degree direction.  
1-3/8" coupling pin with 1" Collar. Fixed in frame with Spring Retainer Pin  
Q345 High Tensile Strength Tube for vertical legs.

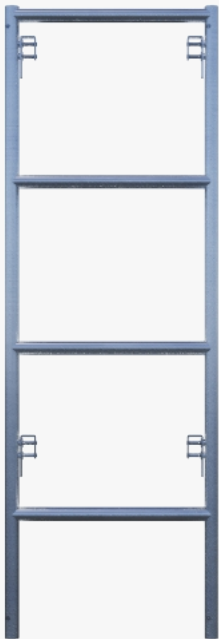

Item No.	Description	Weight (kgs)	Weight (lbs)	Surface Treatment
FS0494	2' x 3' Ladder Frame-V Lock	9.23	20.33	Powder Coated
FS0495	2' x 5' Ladder Frame-V Lock	13.24	29.16	Powder Coated
FS0500	2' x 6'4" Ladder Frame-V Lock	16.33	35.97	Powder Coated
FS0578	2' x 3' Ladder Frame-Slide Lock	9.63	21.21	Powder Coated
FS0579	2' x 5' Ladder Frame-Slide Lock	13.65	30.07	Powder Coated
FS0037	2' x 6'4" Ladder Frame-Slide Lock	16.73	36.85	Powder Coated



Waco Style Frame Scaffolding

Walk Through Frame - "W" Style(1.625" OD), 7" measured from top frame to first lock, 2.5" from top frame to first hole at 45 degree direction.  
1-3/8" coupling pin with 1" Collar. Fixed in frame with Spring Retainer Pin.  
Q345 High Tensile Strength Tube for vertical legs.

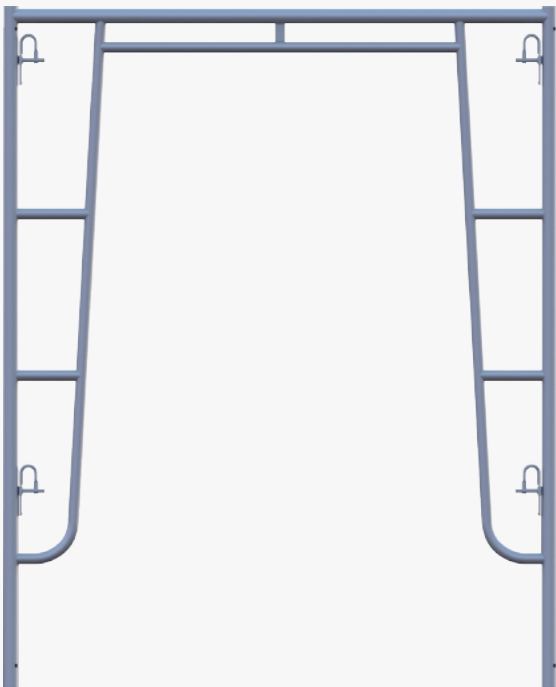

Item No.	Description	Weight (kgs)	Weight (lbs)	Surface Treatment
FS0501	3' x 6'4" Walk Thru Frame-Fast Lock	18.70	41.19	Powder Coated
FS0508	42" x 6'4" Walk Thru Frame-Fast Lock	19.20	42.29	Powder Coated
FS0509	5' x 6'4" Walk Thru Frame-Fast Lock	21.70	47.80	Powder Coated

Waco Style Frame Scaffolding

Mason Frame - "W" Style(1.625" OD), 7" measured from top frame to first lock, 2.5" from top frame to first hole at 45 degree direction.  
1-3/8" coupling pin with 1" Collar. Fixed in frame with Spring Retainer Pin.  
Q345 High Tensile Strength Tube for vertical legs.

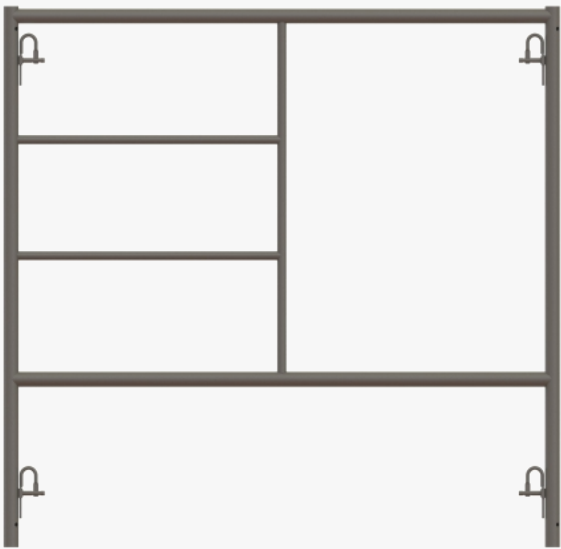

Item No.	Description	Weight (kgs)	Weight (lbs)	Surface Treatment
FS0511	5' x 3' Mason Frame-Fast Lock	14.10	31.06	Powder Coated
FS0513	5' x 4' Mason Frame-Fast Lock	17.20	37.89	Powder Coated
FS0514	5' x 5' Mason Frame-Fast Lock	18.60	40.97	Powder Coated
FS0523	5' x 6'4" Mason Frame-Fast Lock	21.30	46.92	Powder Coated

Canadian Frame System

Walk Thru frame (1.69"), 6" measured from top frame to first lock, 2.5" from top frame to first hole at 90 degree direction.  
1-3/8" coupling pin with 1" Collar. Fixed in frame with Spring Retainer Pin.  
Q345 High Tensile Strength Tube for vertical legs.

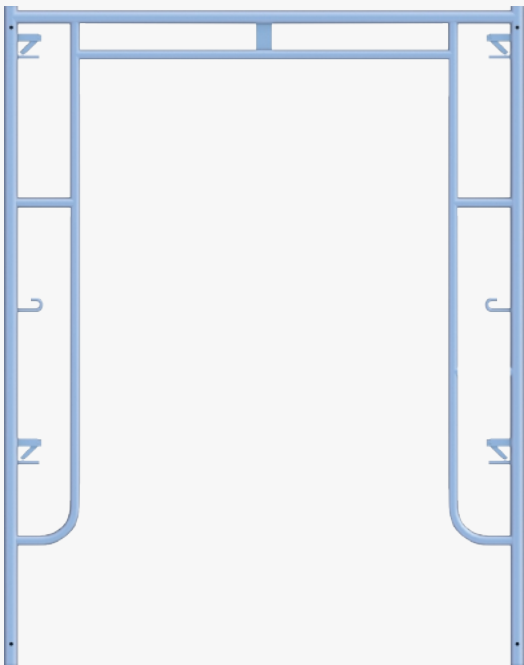

Item No.	Description	Weight (kgs)	Weight (lbs)	Surface Treatment
FS0530	3' x 6'6" Walk Thru Frame-Canadian Lock	19.30	42.51	Powder Coated
FS0544	45" x 6'6" Walk Thru Frame-Canadian Lock	19.80	43.61	Powder Coated
FS0545	5' x 6'6" Walk Thru Frame-Canadian Lock	20.50	45.15	Powder Coated

Canadian Frame System

Mason frame (1.69"), 6" measured from top frame to first lock, 2.5" from top frame to first hole at 90 degree direction.

1-3/8" coupling pin with 1" Collar. Fixed in frame with Spring Retainer Pin.

Q345 High Tensile Strength Tube for vertical legs.

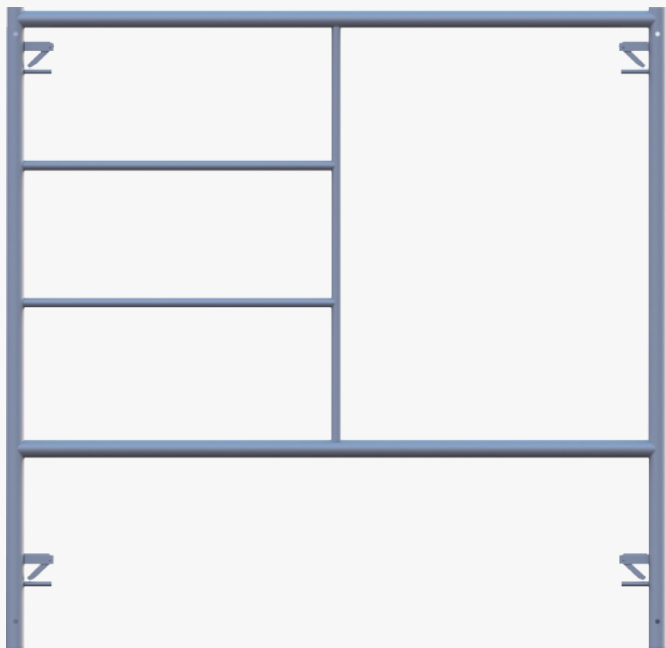

Item No.	Description	Weight (kgs)	Weight (lbs)	Surface Treatment
FS0546	5' x 5' Mason Frame-Canadian Lock	19.50	42.95	Powder Coated
FS0547	5' x 6'6' Mason Frame-Canadian Lock	21.50	47.36	Powder Coated

Shoring Frame System

Steel Shoring Frame (2.37" OD), 7" (13" for 4'x6' shoring frame) measured from top frame to first lock, 1.5" from top frame to first hole at 90 degree direction.  
Q345 High Tensile Strength Tube for vertical legs.

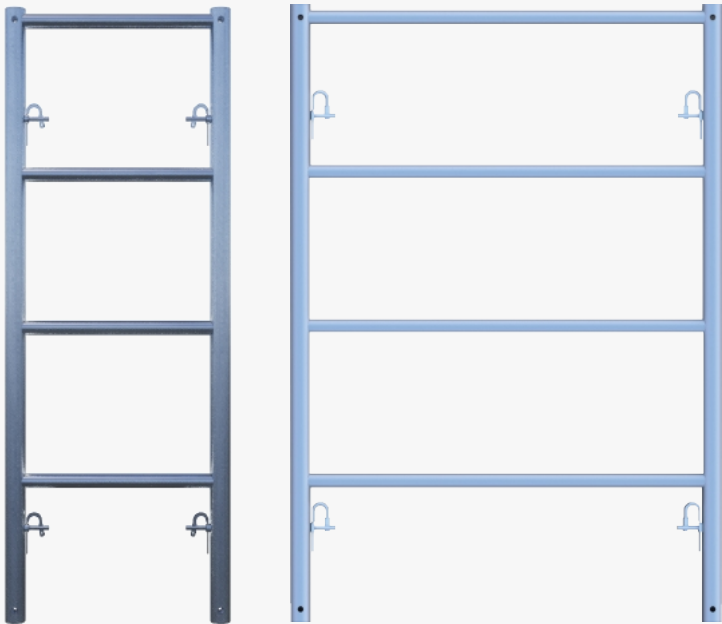

Item No.	Description	Weight (kgs)	Weight (lbs)	Surface Treatment
FS0551	2' x 3' Steel Shoring Frame -Fast Lock	13.40	29.52	Powder Coated
FS0552	2' x 4' Steel Shoring Frame -Fast Lock	18.05	39.76	Powder Coated
FS0553	2' x 5' Steel Shoring Frame -Fast Lock	21.40	47.14	Powder Coated
FS0554	2' x 6' Steel Shoring Frame -Fast Lock	26.10	57.49	Powder Coated
FS0549	4' x 3' Steel Shoring Frame -Fast Lock	16.20	35.68	Powder Coated
FS0550	4' x 4' Steel Shoring Frame -Fast Lock	22.30	49.12	Powder Coated
FS0510	4' x 5' Steel Shoring Frame -Fast Lock	25.70	56.61	Powder Coated
FS0548	4' x 6' Steel Shoring Frame -Fast Locka	31.80	70.04	Powder Coated

Shoring Frame System

Aluminum Shoring Frame (2.85" OD), 8.69" measured from top frame to first lock, 2.75" from top frame to first hole at 90 degree direction.  
6061-T6 High Tensile Strength Tube for all aluminum tubes.



Item No.	Description	Weight (kgs)	Weight (lbs)	Surface Treatment
FS0422	4' x 3' Aluminum Shoring Frame-Drop Lock	9.40	20.70	Aluminum
FS0097	4' x 4' Aluminum Shoring Frame-Drop Lock	12.62	27.80	Aluminum
FS0099	4' x 5' Aluminum Shoring Frame-Drop Lock	16.12	35.51	Aluminum
FS0425	4' x 6' Aluminum Shoring Frame-Drop Lock	18.62	41.01	Aluminum
FS0555	4' x 8' Aluminum Shoring Frame-Drop Lock	24.72	54.45	Aluminum

Accessories

Snap-on Cross Brace (1" OD, 25.4x1.8mm)

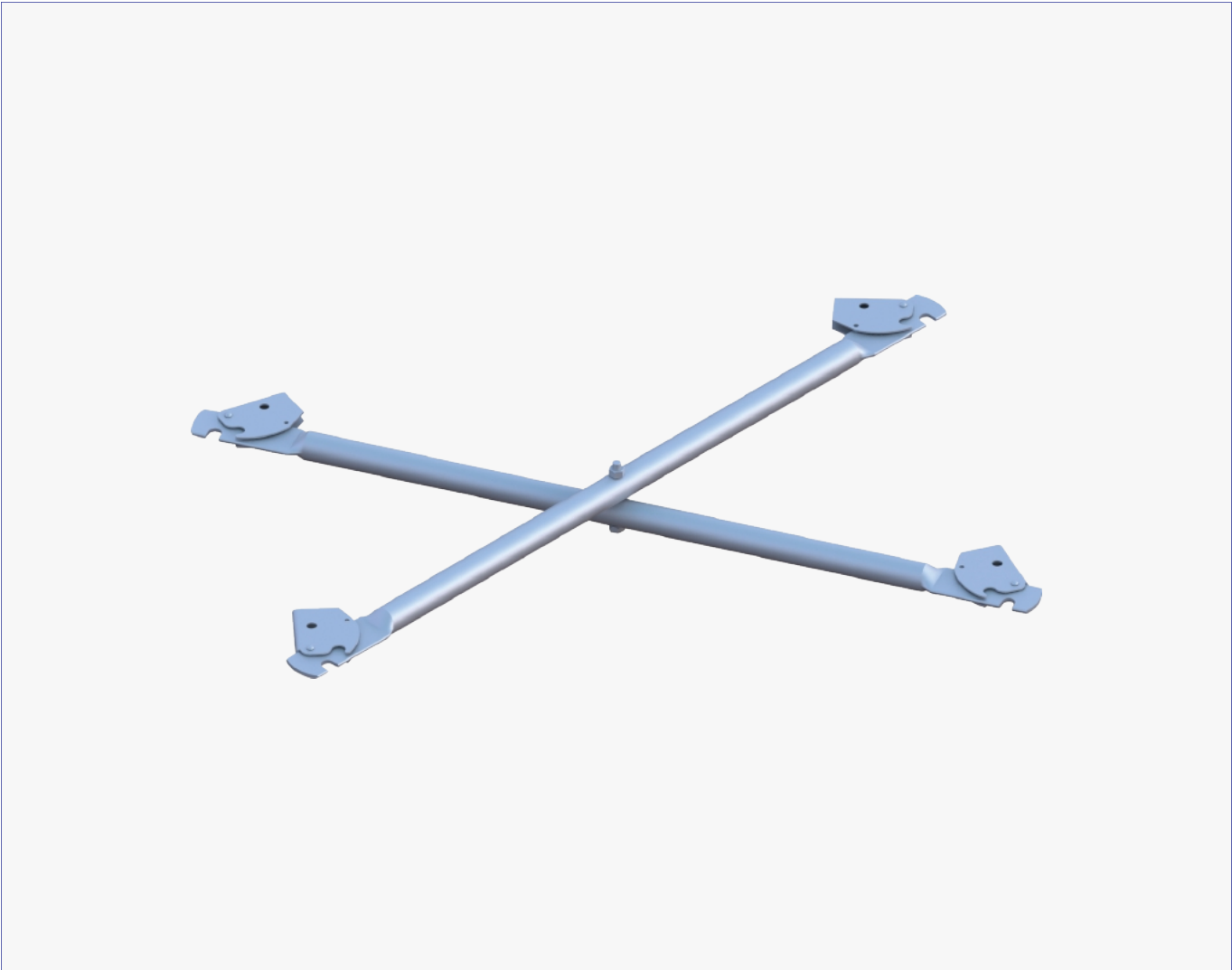

Item No.	Description	Weight (kgs)	Weight (lbs)	Surface Treatment
FS0169	5' x 32" Snap On Cross Brace	4.45	9.80	Pre-galvanized
FS0170	5' x 48" Snap On Cross Brace	4.95	10.90	Pre-galvanized
FS0326	7' x 32" Snap On Cross Brace	5.65	12.44	Pre-galvanized
FS0205	7' x 48" Snap On Cross Brace	6.00	13.22	Pre-galvanized
FS0325	10' x 32" Snap On Cross Brace	7.50	16.52	Pre-galvanized
FS0010	10' x 48" Snap On Cross Brace	7.90	17.40	Pre-galvanized

Accessories

Snap-on Rail (1.26" OD, 32x2mm)

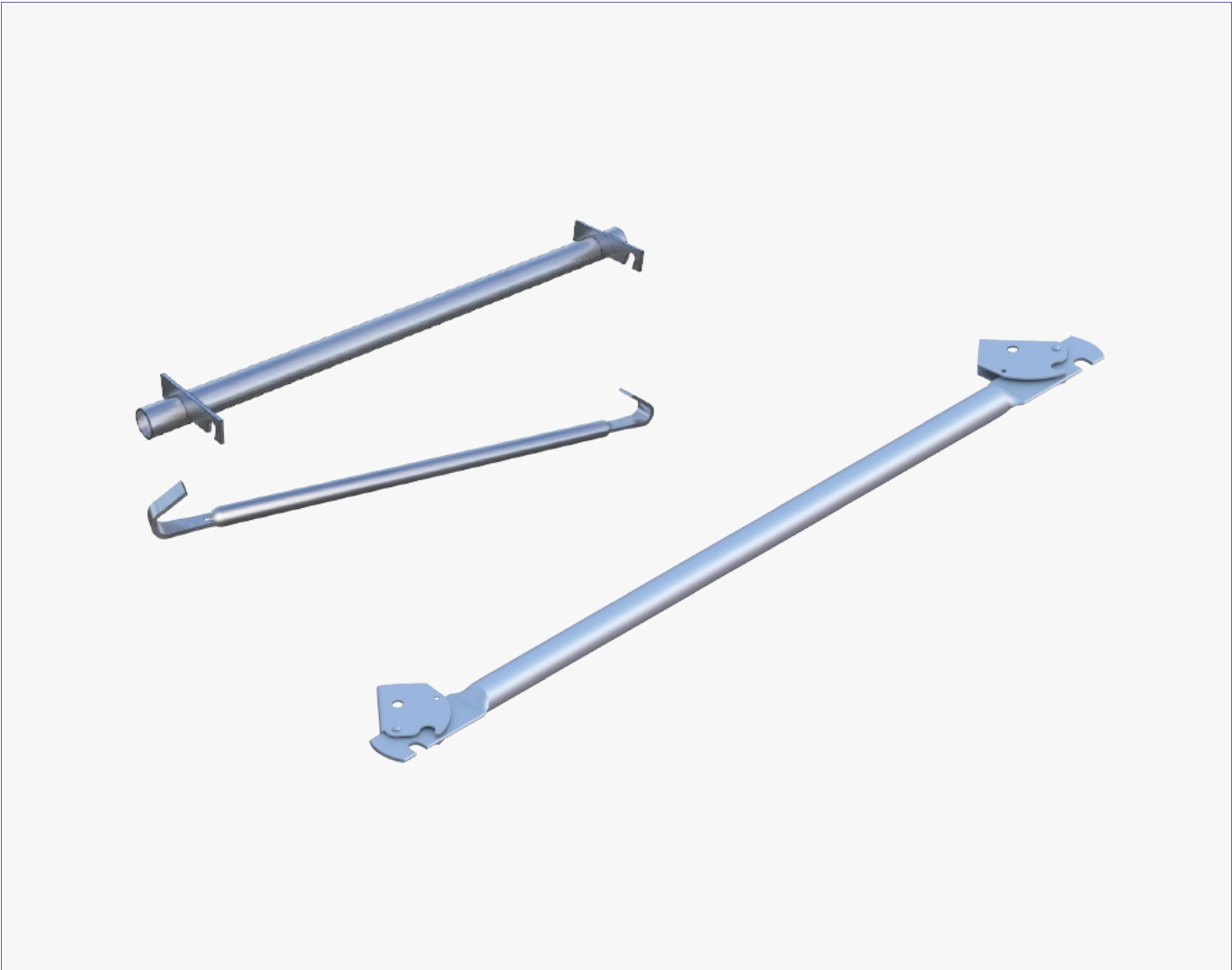

Item No.	Description	Weight (kgs)	Weight (lbs)	Surface Treatment
FS0064	3' Snap On Guard Rail	1.70	3.74	Pre-galvanized
FS0172	5' Snap On Guard Rail	2.50	5.51	Pre-galvanized
FS0207	7' Snap On Guard Rail	3.30	7.27	Pre-galvanized
FS0012	10' Snap On Guard Rail	5.00	11.01	Pre-galvanized
FS0658	3' End Bar	1.20	2.64	Pre-galvanized
FS0655	3' Ledger Hook with blade	1.90	4.19	Pre-galvanized



Accessories

Angle Iron Cross Brace.

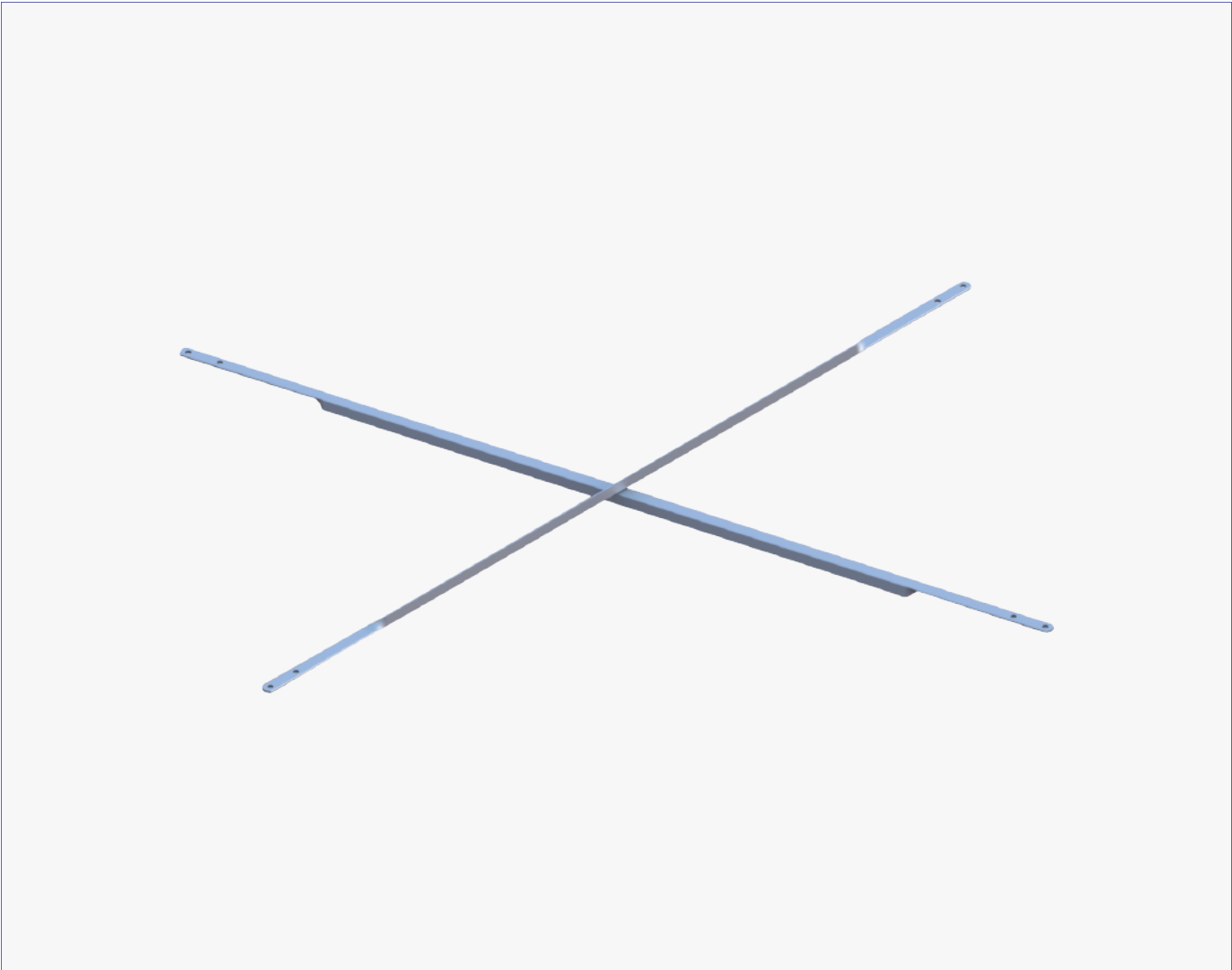

Item No.	Description	Weight (kgs)	Weight (lbs)	Surface Treatment
FS0095	4' x 3' x 4' Angle Iron Cross Brace	4.90	10.79	Electroplated
FS0556	5' x 3' x 4' Angle Iron Cross Brace	5.50	12.11	Electroplated
FS0557	6' x 3' x 4' Angle Iron Cross Brace	6.20	13.66	Electroplated
FS0194	7' x 3' x 4' Angle Iron Cross Brace	6.90	15.20	Electroplated
FS0558	8' x 3' x 4' Angle Iron Cross Brace	7.70	16.96	Electroplated
FS0344	10' x 3' x 4' Angle Iron Cross Brace	9.20	20.26	Electroplated

Accessories

Punch Hole Cross Brace (1" OD, 25.4x1.8mm)

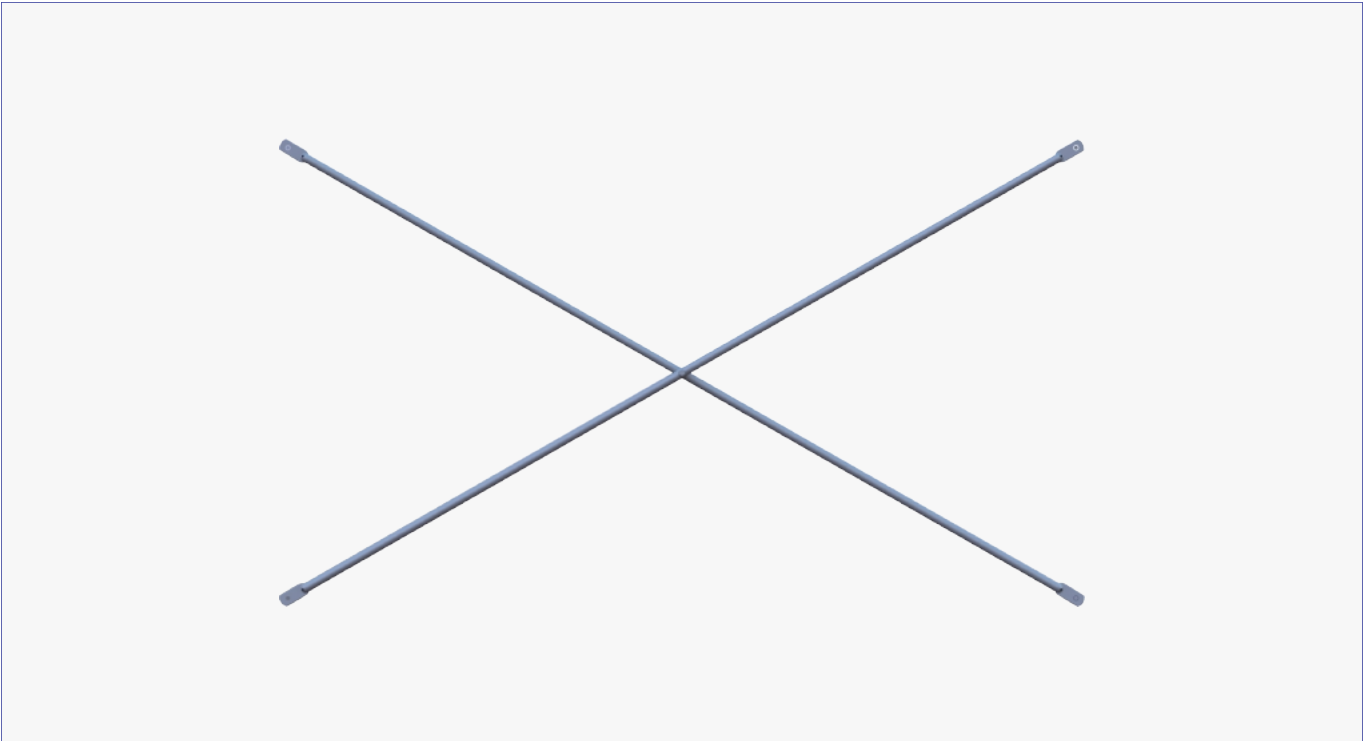

Item No.	Description	Weight (kgs)	Weight (lbs)	Surface Treatment
FS0559	4' x 2' Punched Hole Cross Brace	3.10	6.83	Pre-galvanized
FS0098	4' x 4' Punched Hole Cross Brace	3.90	8.59	Pre-galvanized
FS0136	5' x 2' Punched Hole Cross Brace	3.70	8.15	Pre-galvanized
FS0148	5' x 4' Punched Hole Cross Brace	4.40	9.69	Pre-galvanized
FS0560	6' x 2' Punched Hole Cross Brace	4.30	9.47	Pre-galvanized
FS0177	6' x 4' Punched Hole Cross Brace	4.90	10.79	Pre-galvanized
FS0192	7' x 2' Punched Hole Cross Brace	5.00	11.01	Pre-galvanized
FS0195	7' x 4' Punched Hole Cross Brace	5.30	11.67	Pre-galvanized
FS0214	8' x 2' Punched Hole Cross Brace	5.60	12.33	Pre-galvanized
FS0215	8' x 4' Punched Hole Cross Brace	5.80	12.78	Pre-galvanized
FS0007	10' x 2' Punched Hole Cross Brace	6.70	14.76	Pre-galvanized
FS0009	10' x 4' Punched Hole Cross Brace	7.10	15.64	Pre-galvanized

Accessories

Punch hole Guard Rail (1" or 1.26" OD, 25.4x1.8mm or 32x2mm).

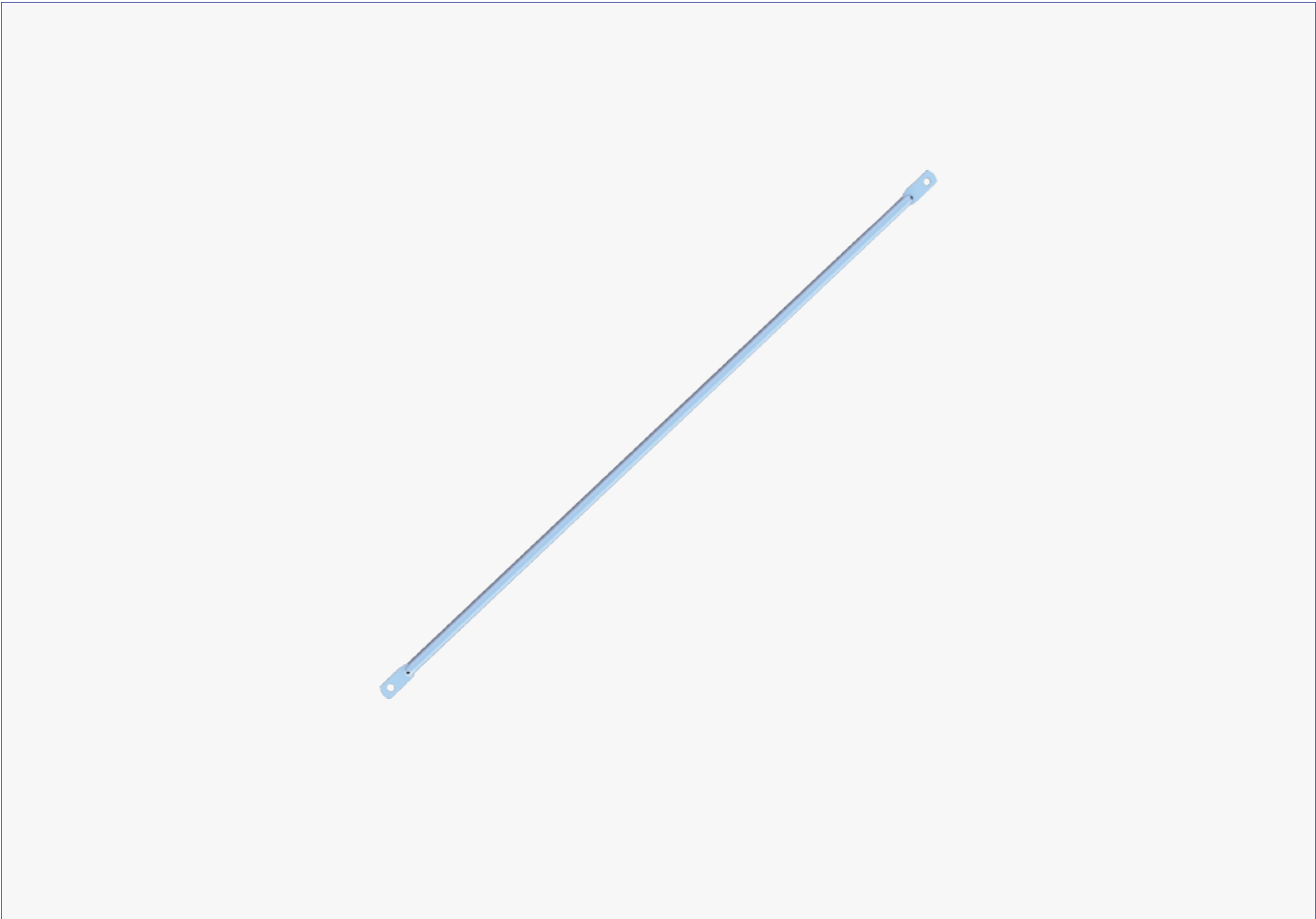

Item No.	Description	Weight (kgs)	Weight (lbs)	Surface Treatment
FS0092	3' Punched Hole Guard Rail	1.30	2.86	Pre-galvanized
FS0117	42" Punched Hole Guard Rail	1.55	3.41	Pre-galvanized
FS0125	4' Punched Hole Guard Rail	1.80	3.96	Pre-galvanized
FS0173	5' Punched Hole Guard Rail	2.20	4.85	Pre-galvanized
FS0186	6' Punched Hole Guard Rail	2.60	5.73	Pre-galvanized
FS0212	7' Punched Hole Guard Rail	3.00	6.61	Pre-galvanized
FS0222	8' Punched Hole Guard Rail	3.40	7.49	Pre-galvanized
FS0016	10' Punched Hole Guard Rail	4.70	10.35	Pre-galvanized

Accessories

Gooser (1.625" OD, 41.3x2.3mm).

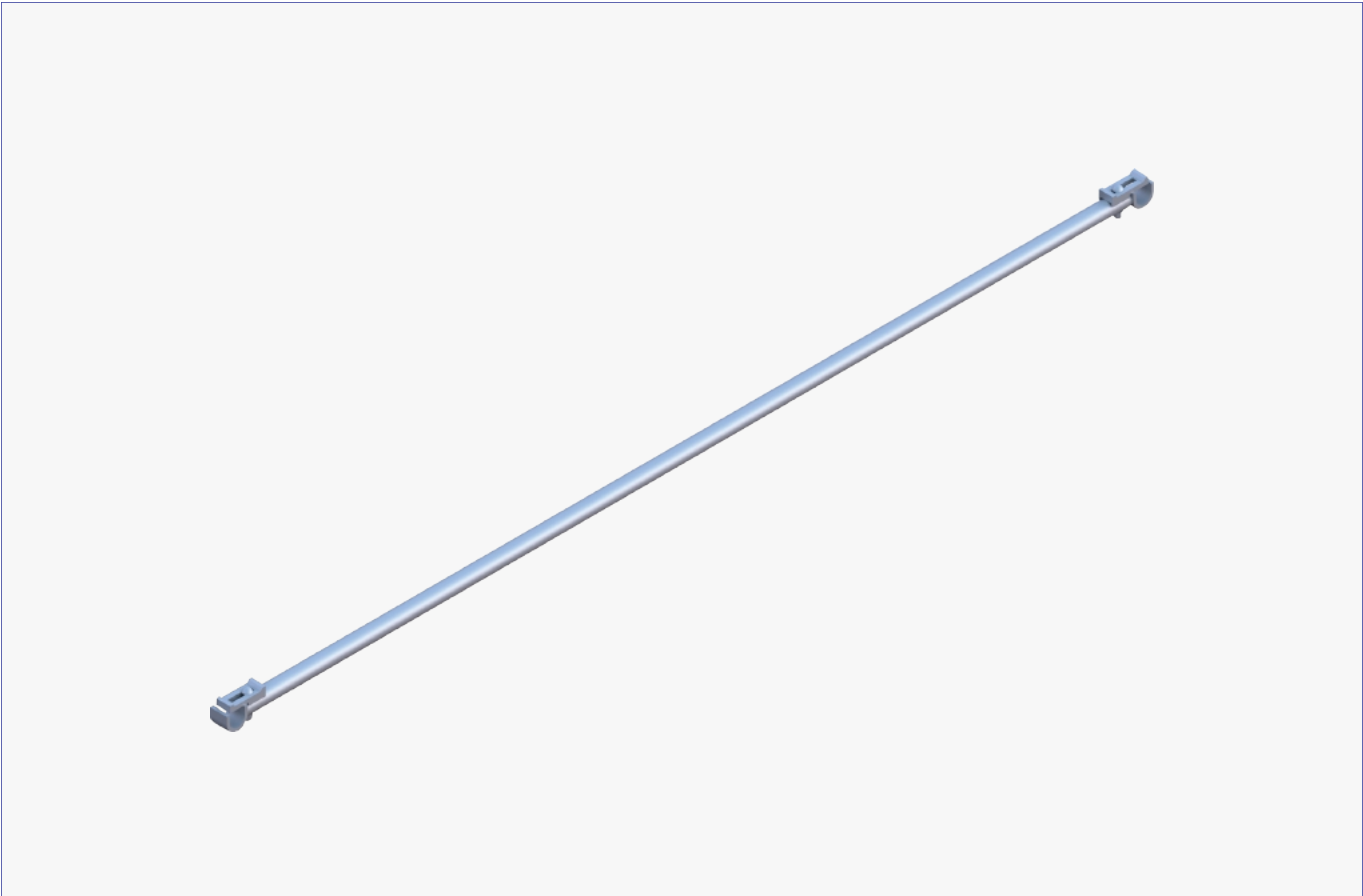

Item No.	Description	Weight (kgs)	Weight (lbs)	Surface Treatment
FS0652	3' Horizontal Gooser	3.50	7.71	Powder Coated
FS0561	5' Horizontal Gooser	4.80	10.57	Powder Coated
FS0653	7' Horizontal Gooser	6.20	13.66	Powder Coated
FS0654	10' Horizontal Gooser	8.20	18.06	Powder Coated

Accessories

Gurad Rail Post (1.625" OD, 41.3x2.3mm).

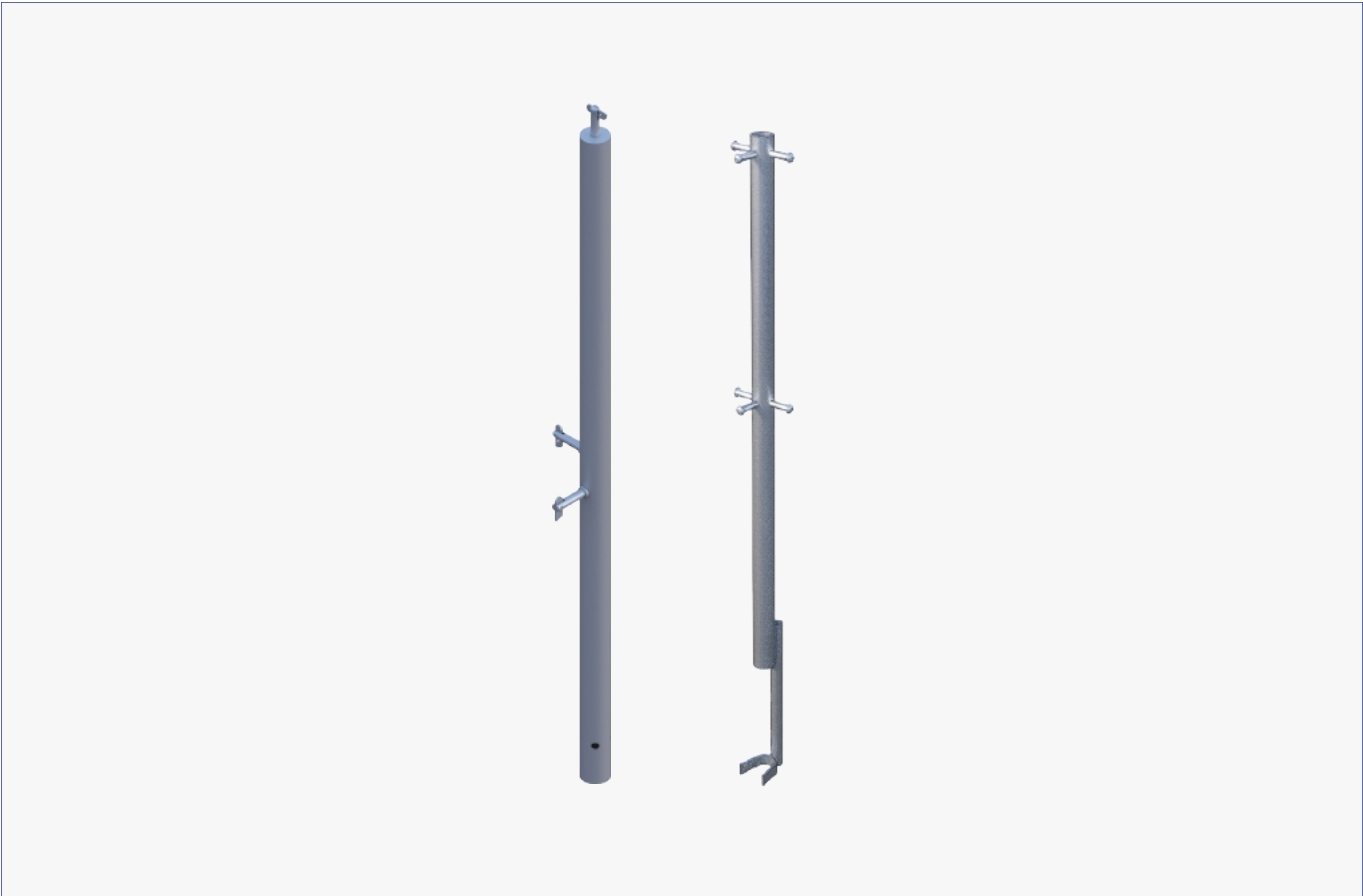

Item No.	Description	Weight (kgs)	Weight (lbs)	Surface Treatment
FS0397	Guard Rail Post with kicker (Snap On Lock)	3.30	7.27	Powder Coated
FS0389	Guard Rail Post-Female (Flip Lock)	2.70	5.95	Powder Coated
FS0562	Guard Rail Post-Male (Flip Lock)	3.00	6.61	Powder Coated
FS0304	Guard Rail Post with kicker (Flip Lock)	3.20	7.05	Powder Coated

Accessories

Folding A-Frame & Mortar Board Stand.

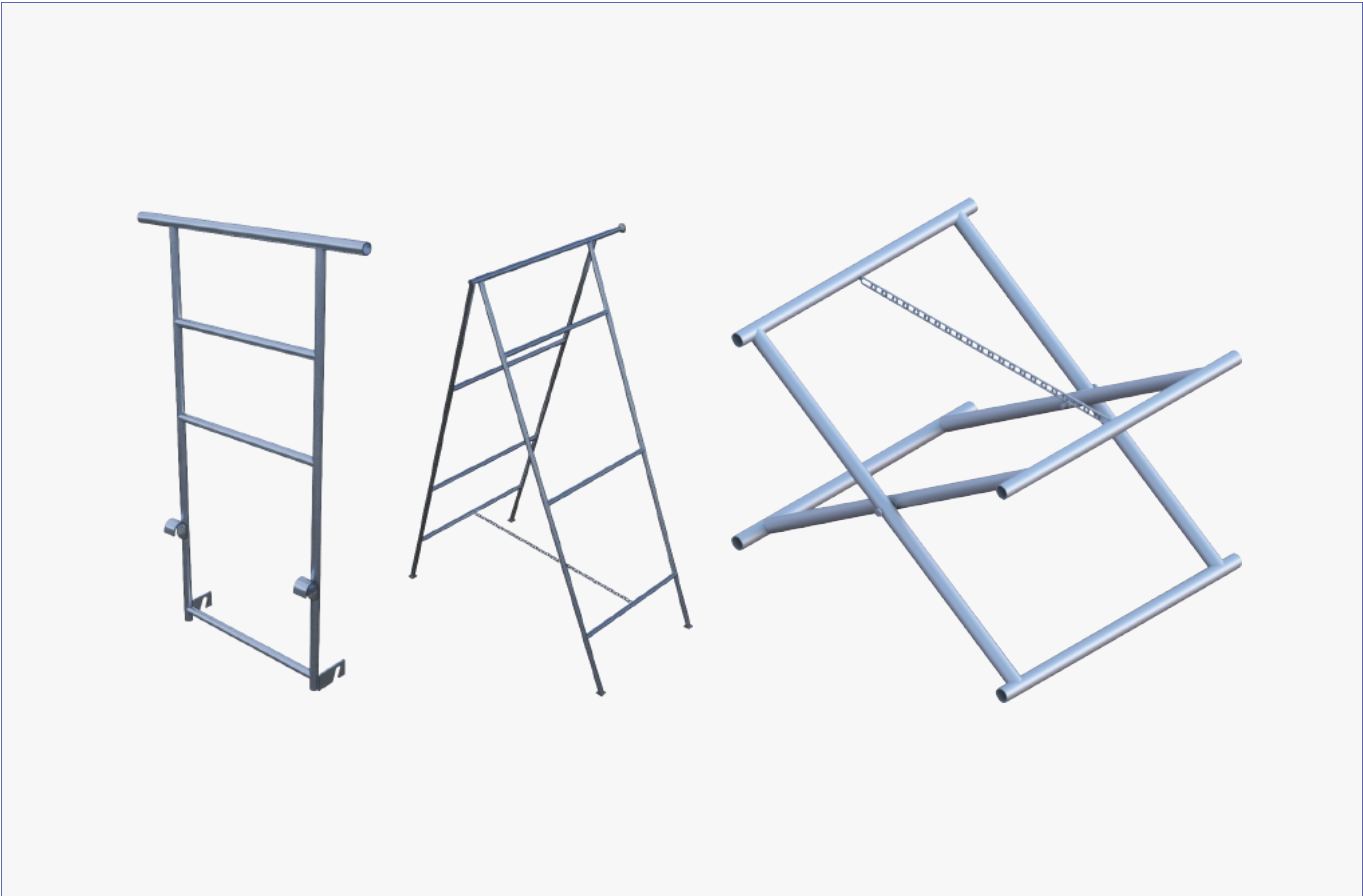

Item No.	Description	Weight (kgs)	Weight (lbs)	Surface Treatment
FS0643	2' Folding "A" Frame (Trestle)	6.90	15.20	Powder Coated
FS0644	3' Folding "A" Frame (Trestle)	9.00	19.82	Powder Coated
FS0645	4' Folding "A" Frame (Trestle)	11.20	24.67	Powder Coated
FS0646	6' Folding "A" Frame (Trestle)	18.00	39.65	Powder Coated
FS0647	2' Folding "A" Frame Extension	4.80	10.57	Powder Coated
FS0648	3' Folding "A" Frame Extension	6.00	13.22	Powder Coated
AS0189	20" x 30" Double Chain Mortar Board Stand	6.80	14.98	Powder Coated

Accessories

Aluminum Walking Boards with hooks.

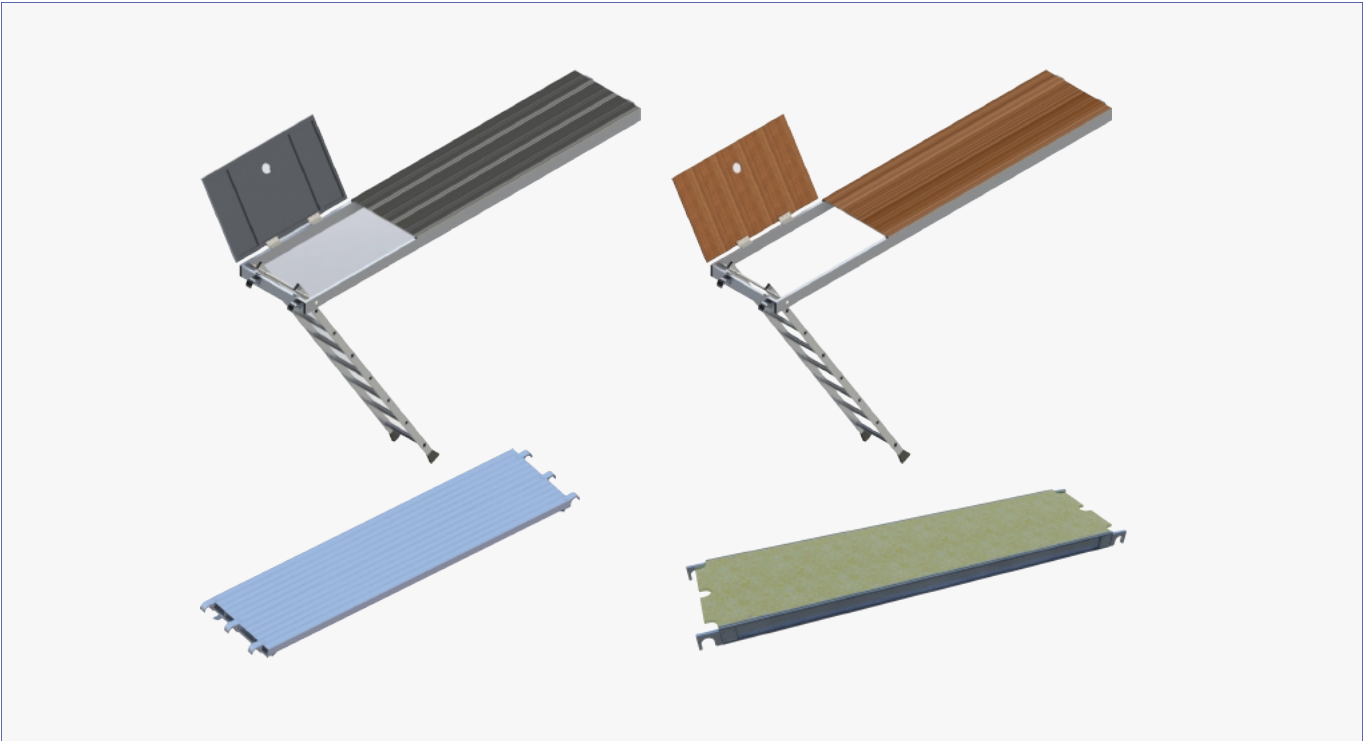

Item No.	Description	Weight (kgs)	Weight (lbs)	Surface Treatment
WP0107	19-1/4" x 5' All Aluminum Plank	11.00	24.23	Aluminum
WP0108	19-1/4" x 7' All Aluminum Plank	13.00	28.63	Aluminum
WP0109	19-1/4" x 8' All Aluminum Plank	15.00	33.04	Aluminum
WP0110	19-1/4" x 10' All Aluminum Plank	18.00	39.65	Aluminum
WP0103	19-1/4" x 5' Aluminum Plywood Deck	13.00	28.63	Aluminum-Plywood
WP0104	19-1/4" x 7' Aluminum Plywood Deck	16.90	37.22	Aluminum-Plywood
WP0105	19-1/4" x 8' Aluminum Plywood Deck	18.60	40.97	Aluminum-Plywood
WP0106	19-1/4" x 10' Aluminum Plywood Deck	23.30	51.32	Aluminum-Plywood
WP0130	28" x 7' Aluminum Plywood Hatch Plank with ladder	33.63	74.07	Aluminum-Plywood
WP0136	28" x 10' Aluminum Plywood Hatch Plank with ladder	41.23	90.81	Aluminum-Plywood
WP0119	28" x 7' All Aluminum Hatch Plank with ladder	39.50	87.00	Aluminum
WP0120	28" x 7' All Aluminum Hatch Plank with ladder	47.90	105.51	Aluminum

Accessories

Adjustable Legs and Base Plates.



Item No.	Description	Weight (kgs)	Weight (lbs)	Surface Treatment
AS0026	24" Screw Jack with socket	5.00	11.01	Electroplated
AS0198	24" Screw Jack with base plate	5.60	12.33	Electroplated
AS0033	24" Swivel Screw Jack with base plate	6.50	14.32	Electroplated
FS0052	24" Extension Base Plate	1.80	3.96	Electroplated
FS0324	5"x5" Base Plate	1.00	2.20	Electroplated
FS0171	5"x5" Swivel Base Plate	1.30	2.86	Electroplated



Accessories

Stairs.

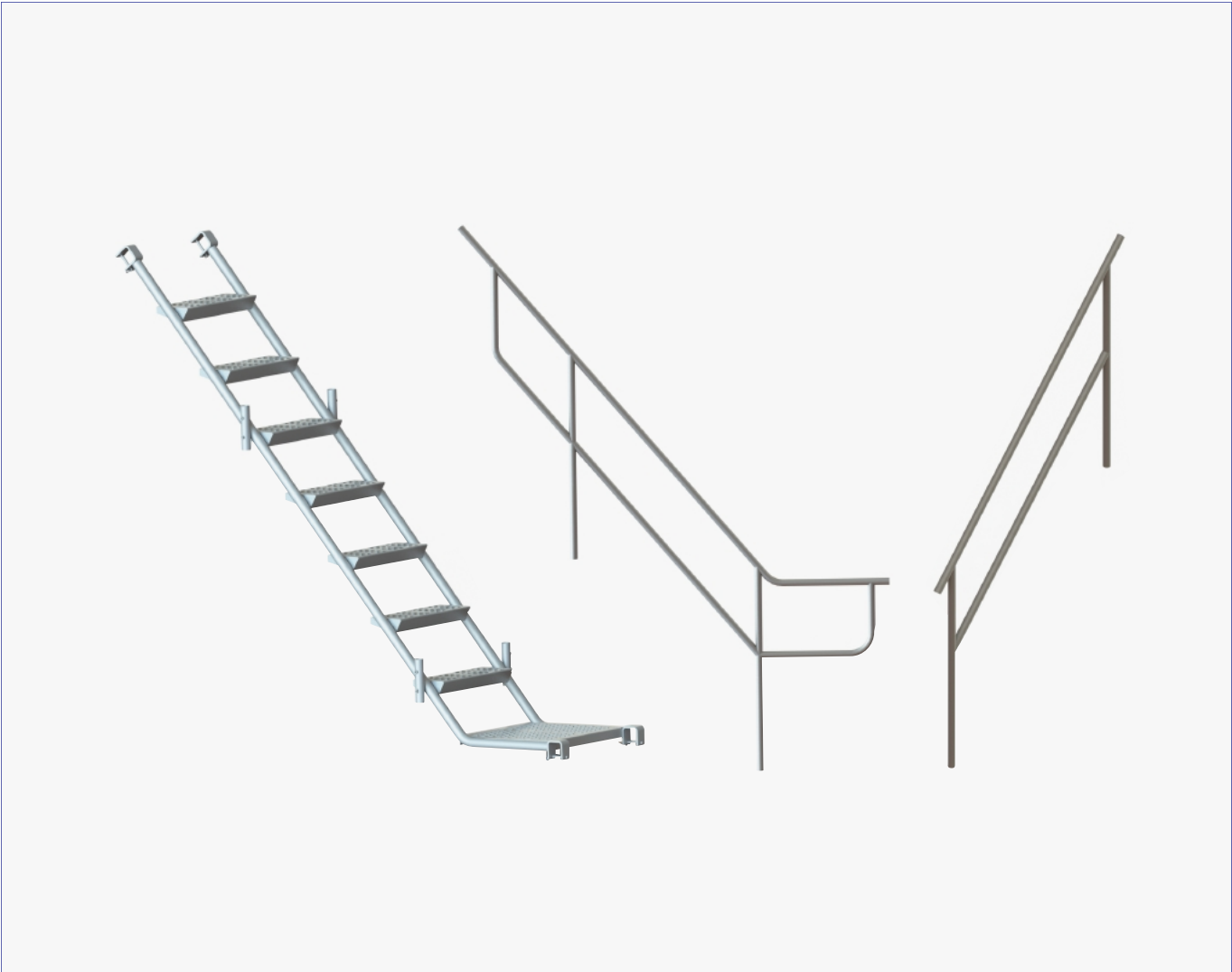

Item No.	Description	Weight (kgs)	Weight (lbs)	Surface Treatment
FS0199	7' x 6'4" Stairs with handrail (for 6'4" height frame)	52.00	114.54	Powder Coated
FS0463	7' x 6'8" Stairs with handrail (for 6'8" height frame)	54.00	118.94	Powder Coated
FS0218	8' x 6'4" Stairs with handrail (for 6'4" height frame)	54.00	118.94	Powder Coated

Accessories

Coupling Pin.



Item No.	Description	Weight (kgs)	Weight (lbs)	Surface Treatment
FS0006	1-5/16" OD Coupling Pin (1/8" Collar)	0.30	0.66	Electroplated
FS0002	1-5/16"OD Coupling Pin (No Collar)	0.25	0.55	Electroplated
FS0017	1-3/8" OD Coupling Pin (1" Collar)	0.45	0.99	Electroplated
FS0001	1-7/16" OD Coupling Pin (1" Collar)	0.50	1.10	Electroplated

Accessories

Pins & Lock.



Item No.	Description	Weight (kgs)	Weight (lbs)	Surface Treatment
FS0018	Roll Pin	0.02	0.04	Electroplated
FS0265	3" Toggle Pin	0.07	0.15	Electroplated
FS0247	Snap Pin	0.06	0.13	Electroplated
FS0234	Spring Retainer	0.01	0.02	Electroplated
FS0289	Gravity Lock Pin (Pig Tail)	0.10	0.22	Electroplated

Accessories

Ladders & Bracket.

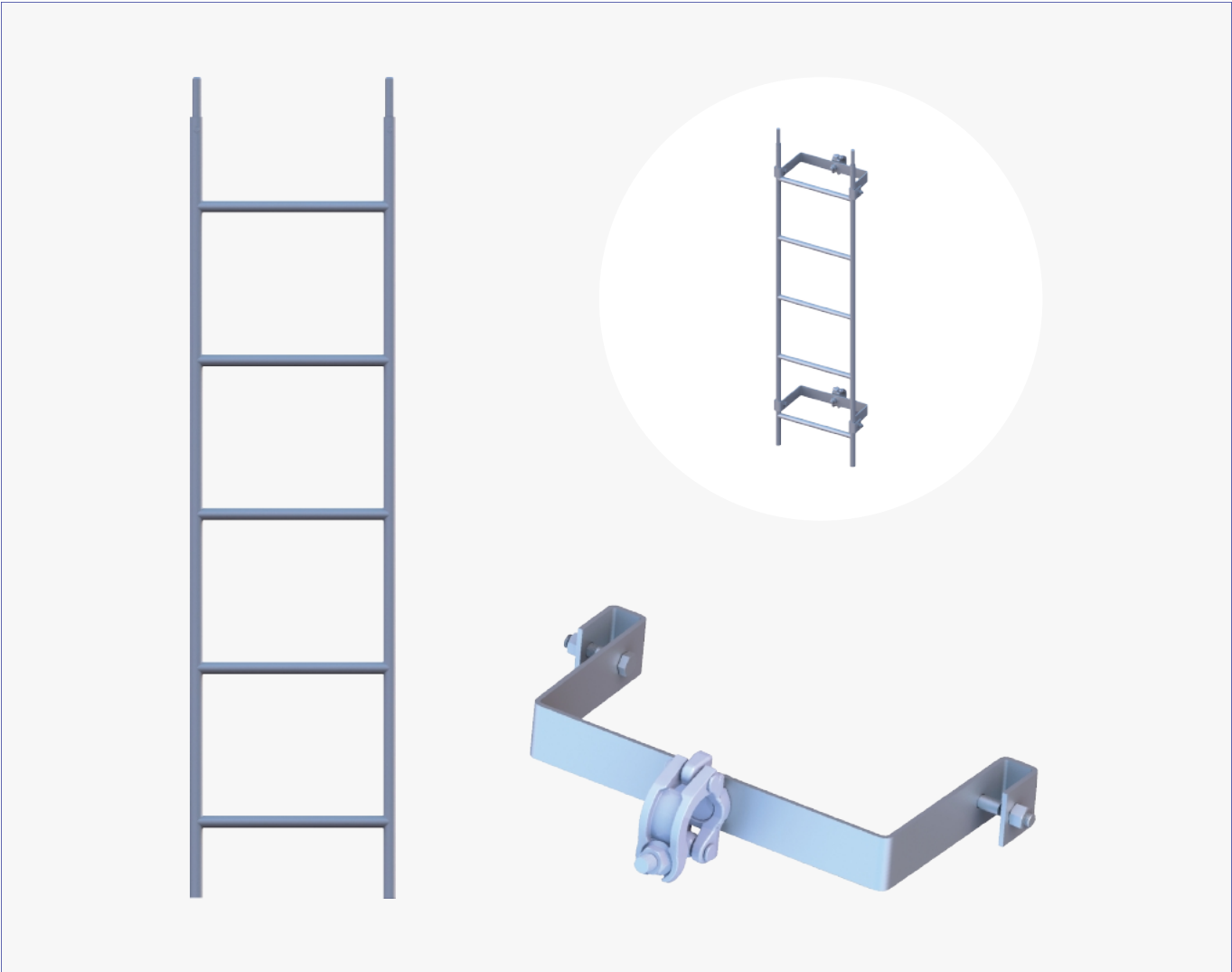

Item No.	Description	Weight (kgs)	Weight (lbs)	Surface Treatment
FS0487	3' x 15" Access Ladder	4.20	9.25	Powder Coated
FS0175	5' x 15" Access Ladder	6.00	13.22	Powder Coated
FS0377	6' x 15" Access Ladder	7.50	16.52	Powder Coated
FS0376	Access Ladder Bracket	2.50	5.51	Powder Coated

Accessories

Safety Gate.

				
Item No.	Description	Weight (kgs)	Weight (lbs)	Surface Treatment
FS0664	3' ~ 5' Safety Gate	14.40	31.72	Electroplated

Accessories

Hoist Arm and wheel.

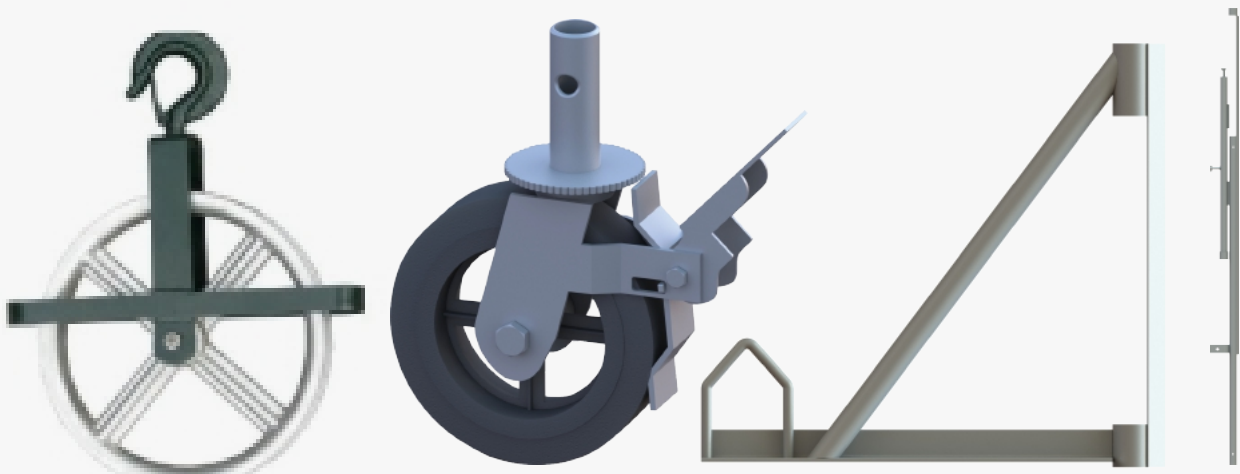
				
Item No.	Description	Weight (kgs)	Weight (lbs)	Surface Treatment
FS0019	12" Well/Pulley Wheel	3.60	7.93	Aluminum
FS0250	Hoist Arm for Wheel	15.10	33.26	Steel
FS0213	8" Scaffold Caster with Brake	5.30	11.67	Steel

Accessories

Side Bracket.

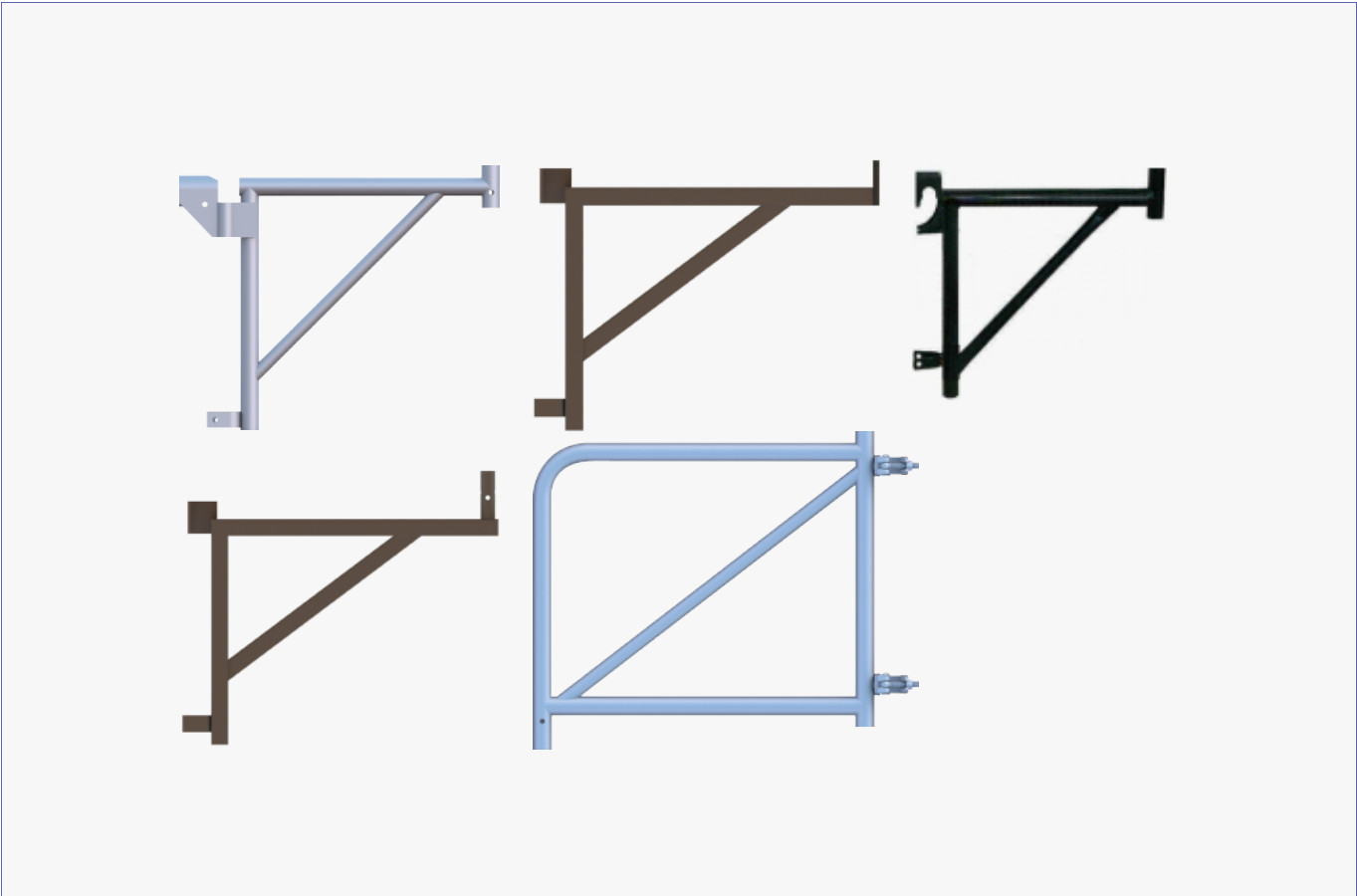

Item No.	Description	Weight (kgs)	Weight (lbs)	Surface Treatment
FS0086	30" Outriggers	9.00	19.82	Powder Coated
FS0044	20" Saddle Hanger Side Bracket	5.00	11.01	Powder Coated
FS0084	30" Saddle Hanger Side Bracket	6.50	14.32	Powder Coated
FS0649	12" Angle Iron Side Bracket	3.14	6.92	Powder Coated
FS0650	20" Angle Iron Side Bracket	4.50	9.91	Powder Coated
FS0683	30" Angle Iron Side Bracket	6.00	13.22	Powder Coated
FS0543	20" End Bracket	4.00	8.81	Powder Coated
FS0486	30" End Bracket	5.50	12.11	Powder Coated
FS0424	20" Angle Iron Side Bracket with Stud	4.40	9.69	Powder Coated

Accessories

Steel Shoring Frame Accessories.



Item No.	Description	Weight (kgs)	Weight (lbs)	Surface Treatment
FS0033	5.5" Shoring Coupling	0.60	1.32	Electroplated
FS0279	9" x 7" Shoring Base	3.60	7.93	Electroplated
FS0278	8" x 10.5" Shoring U-head	6.00	13.22	Electroplated
AS0034	36" Shoring Screw Jack	8.00	17.62	Electroplated
AS0032	36" Screw Jack with 8" x 10" U head	10.00	22.03	Electroplated
FS0259	Shoring Rivet and Hitch Pin	0.20	0.44	Electroplated



Accessories

Aluminum Shoring Frame Accessories.

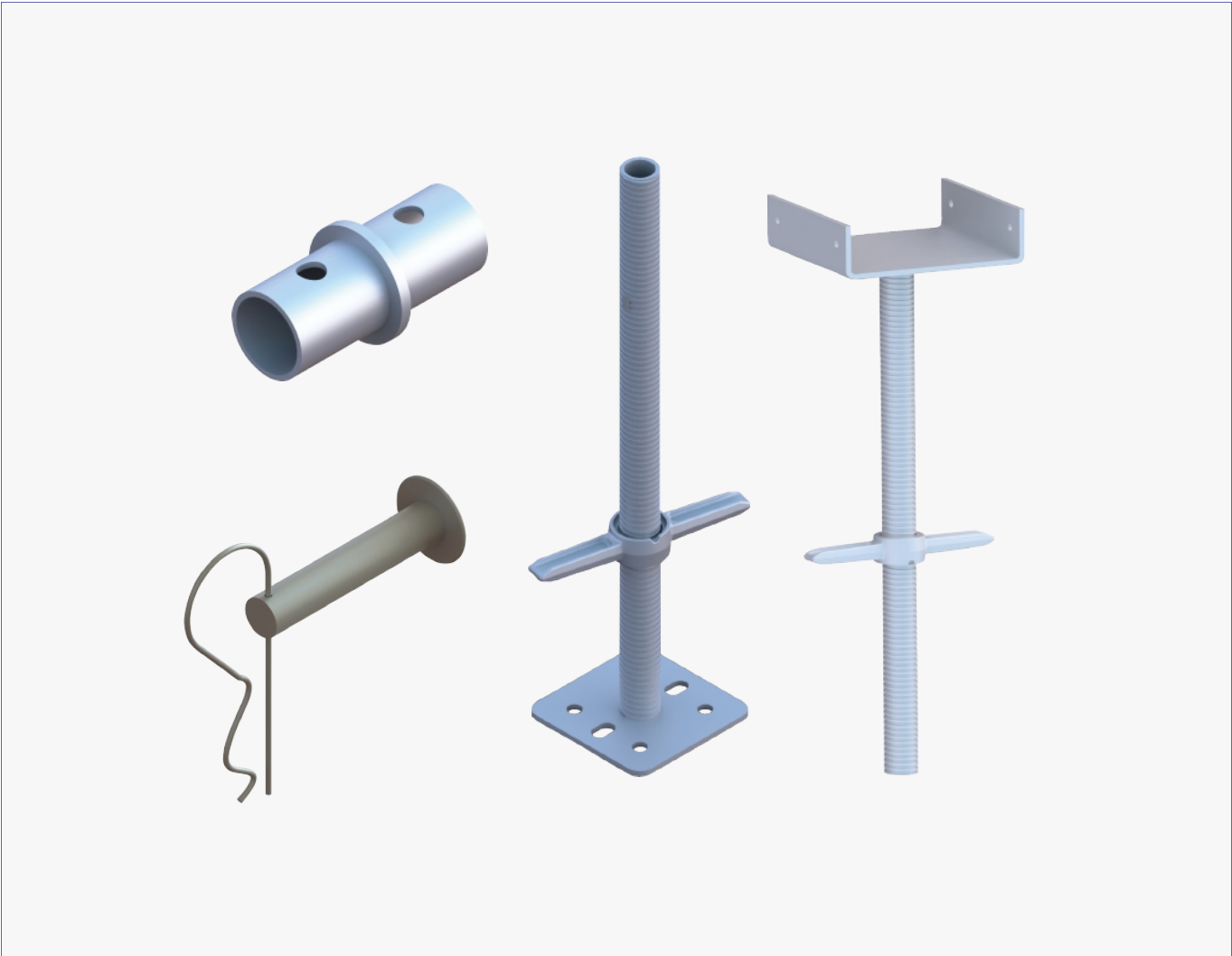

Item No.	Description	Weight (kgs)	Weight (lbs)	Surface Treatment
FS0249	7.5" Shoring Coupling	0.80	1.76	Electroplated
AS0036	30" Shoring Screw Jack with base plate	6.20	13.66	Electroplated
AS0037	30" Shoring Screw Jack with U head	7.40	16.30	Electroplated
FS0224	Shoring Rivet and Hitch Pin	0.35	0.77	Electroplated



# US FRAMES SYSTEM

## CHINA

5 Xinghan Street, Suzhou, Jiangsu 215021

## USA

HOUSTON, TX: 1133 East Airtex Drive Houston, TX 77073

Office. 1-346-340-4113

Toll Free. 1-844-821-0036

## EMAIL

[coronet@scaffolding.com](mailto:coronet@scaffolding.com)

## WEB

[www.scaffolding.com](http://www.scaffolding.com)

We are the leading scaffolding supplier.

CORONET 2025